

**26**

**BAD BOY**  
— IMPLEMENTS —



# **SNOW PUSHER**

## **5', 6', 7'**

### **TRACTOR IMPLEMENTS**

### **OWNER'S OPERATOR SERVICE MANUAL**

For additional information, please see us at  
**[www.badboycountry.com](http://www.badboycountry.com)**

---

## **SECTION 1 BASIC INFORMATION**

**1-3**

Implement Information .....	1-3
Model/Serial Number .....	1-3
Parts/Service .....	1-3
Warranty .....	1-3
Warranty Registration .....	1-3
Implement Specifications .....	1-4
Standard Snow Pusher No Backdrag .....	1-4
Standard Snow Pusher With Backdrag .....	1-5
UHMW Snow Pusher No Backdrag .....	1-5
UHMW Snow Pusher With Backdrag .....	1-5
Accessory Kits .....	1-6
Back Drag Assembly Kit .....	1-6
Back Drag UHMW Assembly Kit .....	1-6
Snow Pusher Metal Skid Kit .....	1-6
Snow Pusher UHMW Skid Kit .....	1-6
Snow Pusher Metal Blade Kit .....	1-6
Snow Pusher UHMW Blade Kit .....	1-6
Mounting Compatibility .....	1-6
Torque Specifications .....	1-7
Metric .....	1-7
SAE .....	1-8

## **SECTION 2 GENERAL SAFETY INFORMATION**

**2-9**

Safety Symbols .....	2-9
Implement Safety Guidelines .....	2-9
Machine Decals .....	2-9
Personal Protective Equipment (PPE) .....	2-11
Operation Safety .....	2-11
General Operation Safety .....	2-11
Preparation .....	2-11
Operation .....	2-12
Slope Operation Safety .....	2-12
Children Safety .....	2-12
Service Safety .....	2-13
General Service .....	2-13

---

<b>SECTION 3 ASSEMBLY AND INSTALLATION</b>	<b>3-14</b>
Mounting .....	3-14
Accessory Kit Installation .....	3-15
Back Drag Assembly Kit.....	3-15
UHMW Skid Kit .....	3-17
UHMW Blade Kit .....	3-18
<b>SECTION 4 OPERATION</b>	<b>4-19</b>
Pre-Operation Checklist.....	4-19
Operating Implement.....	4-20
Back Drag Kit .....	4-21
Tips.....	4-21
<b>SECTION 5 MAINTENANCE</b>	<b>5-22</b>
Routine Maintenance .....	5-22
Rotating Metal Blade.....	5-23
Rotating UHMW Blade .....	5-23
Replacement Parts List.....	5-24
Replacing Worn Components .....	5-24
Metal Skid Shoes .....	5-24
Metal Blade .....	5-25
Replacing Decals .....	5-25
Troubleshooting.....	5-26
Long-Term Storage .....	5-26
Maintenance Log.....	5-27
<b>SECTION 6 LIMITED WARRANTY</b>	<b>6-28</b>
<b>SECTION 7 PARTS</b>	<b>7-31</b>
Quick Reference Chart.....	7-31
5' Parts List.....	7-32
6' Parts List.....	7-38
7' Parts List.....	7-44
Decals .....	7-51

# SECTION 1 BASIC INFORMATION

---

## Implement Information

Congratulations on the purchase of your new Bad Boy Snow Pusher! The purpose of this manual is to assist operators in maintaining and operating the implement. This implement is designed to provide fast, efficient, and safe snow removal. To ensure reliable performance and long service life, it is important that you read and fully understand the instructions in this manual before use. If any information is unclear, please contact your Bad Boy dealer or Bad Boy Mowers, LLC for assistance. While this manual provides general guidance for proper assembly, operation, and maintenance, actual conditions may vary, so operators should use sound judgment to develop safe and effective procedures.

The 5', 6' and 7' Snow Pushers are engineered for seamless compatibility with Bad Boy tractors equipped with the factory quick-attach system. The range of sizes allow flexibility to match implement width to tractor capability, maximizing efficiency and maintaining proper balance during snow-clearing operations.

**5' Snow Pusher:** 1025, 30 series, 40 Series, and 50 Series

**6' and 7' Snow Pusher:** 50 Series

The quick-attach system allows for fast mounting and removal without additional adapters, ensuring a secure and stable connection during operation.

Check out our website to learn more about the Bad Boy family at [www.badboycountry.com](http://www.badboycountry.com).

## Model/Serial Number

Your implement model and serial number are printed on the decal located on the spanning gusset underneath the "Bad Boy Implements" decal. The entire alphanumeric code is your serial number. To find your model number, leave the last eight digits off the serial number. When the time comes, these numbers are necessary for ordering parts. Record the serial number below.

**Serial #** \_\_\_\_\_

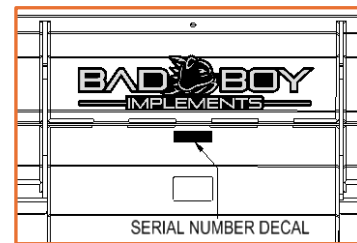

Figure 1-1

## Parts/Service

Bad Boy recommends using Bad Boy replacement parts on your implement. Replacement parts are available through your local Bad Boy dealer. Have both the **part number** and **serial number** available when ordering parts.

All warranty repair and service must be handled through your authorized Bad Boy dealer. To locate the nearest dealer, go to the website listed above and click on "FIND A DEALER".

## Warranty

### Warranty Registration

The warranty registration form must be completed within **30 days** to validate your warranty. As a new equipment owner, it is your responsibility to ensure that the warranty registration form has been completed by the selling dealer at the time of delivery using the online registration site. The warranty is nontransferable.

## Implement Specifications

Bad Boy Snow Pushers are designed for dependable performance and lasting durability in demanding winter conditions. All models share a 21-inch depth, with additional key measurements shown in the following charts and referenced in Figure 1-2. Models are listed in both Standard and Ultra-High-Molecular-Weight Polyethylene (UHMW) construction, with options for configurations that include or exclude the back drag feature. All weights and lengths are approximations.

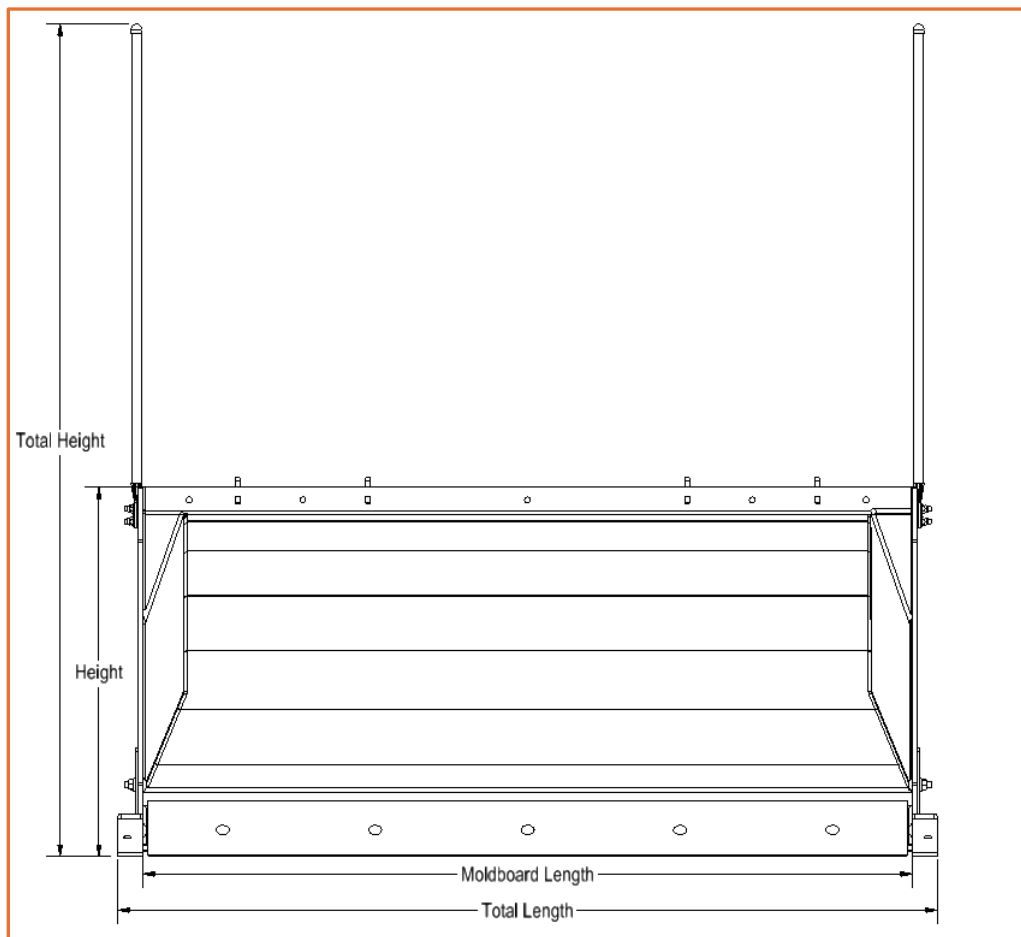

Figure 1-2

### Standard Snow Pusher No Backdrag

SKU	Color	Moldboard Length (in)	Total length (in)	Height (in)	Total Height (in)	Weight (lbs)	Weight with Back Drag Kit (lbs)
BBSP60O	5' Orange	61	65	29	66	470	600
BBSP60BK	5' Black	61	65	29	66	470	600
BBSP72O	6' Orange	73	77	29	66	510	655
BBSP72BK	6' Black	73	77	29	66	510	655
BBSP84O	7' Orange	85	89	29	78	545	710
BBSP84BK	7' Black	85	89	29	78	545	710

**Standard Snow Pusher With Backdrag**

SKU	Color	Moldboard Length (in)	Total length (in)	Height (in)	Total Height (in)	Weight (lbs)
BBSP60BDO	5' Orange	61	65	29	66	600
BBSP60BDBK	5' Black	61	65	29	66	600
BBSP72BDO	6' Orange	73	77	29	66	655
BBSP72BDBK	6' Black	73	77	29	66	655
BBSP84BDO	7' Orange	85	89	29	78	710
BBSP84BDBK	7' Black	85	89	29	78	710

**UHMW Snow Pusher No Backdrag**

SKU	Color	Moldboard Length (in)	Total length (in)	Height (in)	Total Height (in)	Weight (lbs)	Weight with Back Drag Kit (lbs)
BBSP60UHO	5' Orange	61	64	29	66	440	560
BBSP60UHBK	5' Black	61	64	29	66	440	560
BBSP72UHO	6' Orange	73	76	29	66	475	610
BBSP72UHBK	6' Black	73	76	29	66	475	610
BBSP84UHO	7' Orange	85	88	29	78	510	670
BBSP84UHBK	7' Black	85	88	29	78	510	670

**UHMW Snow Pusher With Backdrag**

SKU	Color	Moldboard Length (in)	Total length (in)	Height (in)	Total Height (in)	Weight (lbs)
BBSP60UHBDO	5' Orange	61	64	29	66	560
BBSP60UHBDBK	5' Black	61	64	29	66	560
BBSP72UHBDO	6' Orange	73	76	29	66	610
BBSP72UHBDBK	6' Black	73	76	29	66	610
BBSP84UHBDO	7' Orange	85	88	29	78	670
BBSP84UHBDBK	7' Black	85	88	29	78	670

## Accessory Kits

The Back Drag, Skid, and Blade Kits enhance the performance and versatility of the Bad Boy Snow Pusher. The UHMW components reduce surface friction, allowing snow and debris to roll off smoothly while protecting both the pusher and the operating surface. The Back Drag Kit adds a fixed upper cutting edge that lets operators pull snow backward from tight areas such as building edges, doors, and loading docks. Together, these kits improve material flow, minimize surface damage, and expand the implement's capability in a wide range of snow removal conditions.

### Back Drag Assembly Kit

Kit Number	Size-Color
388-0015-01	5' -Orange
388-0015-07	5' -Black
388-0013-01	6' -Orange
388-0013-07	6' -Black
388-0017-01	7' -Orange
388-0017-07	7' -Black

### Back Drag UHMW Assembly Kit

Kit Number	Size-Color
388-0025-01	5' -Orange
388-0025-07	5' -Black
388-0026-01	6' -Orange
388-0026-07	6' -Black
388-0027-01	7' -Orange
388-0027-07	7' -Black

### Snow Pusher Metal Skid Kit

Kit Number	Color
338-0043-01	Orange
338-0043-07	Black

### Snow Pusher UHMW Skid Kit

Kit Number	Color
338-0038-01	Orange
338-0038-07	Black

### Snow Pusher Metal Blade Kit

Kit Number	Size
338-0044-01	5'
338-0045-01	6'
338-0046-01	7'

### Snow Pusher UHMW Blade Kit



Kit Number	Size-Color
338-0040-01	5' -Orange
338-0040-07	5' -Black
338-0039-01	6' -Orange
338-0039-07	6' -Black
338-0041-01	7' -Orange
338-0041-07	7' -Black

## Mounting Compatibility

The Bad Boy Snow Pusher is engineered for seamless compatibility with Bad Boy tractors equipped with the factory quick-attach system, as well as most machines that use the industry-standard skid-steer-style quick attach. This universal design allows for fast mounting and removal without additional adapters, ensuring a secure and stable connection during operation. Consult your machine's manual to ensure proper operation based on the size and weight of the implement.



## Torque Specifications

### Metric

<b>Metric Bolt Torque</b> Torque estimates based on clamp load (75% of proof strength) as specified in ISO-898-1.						
Size And Thread Pitch	 <b>Class 8.8</b>		 <b>Class 10.9</b>		 <b>12.9 Socket Head Cap Screw</b>	
	Dry	Lubed	Dry	Lubed	Dry	Lubed
M5 X 0.80	54 in•lb 6.1 N•m	41 in•lb 4.6 N•m	78 in•lb 8.8 N•m	59 in•lb 6.7 N•m	91 in•lb 10.3 N•m	68 in•lb 7.7 N•m
M6 X 1.00	92 in•lb 10.4 N•m	69 in•lb 7.8 N•m	133 in•lb 15 N•m	99 in•lb 11.2 N•m	156 in•lb 17.6 N•m	116 in•lb 13.1 N•m
M7 X 1.00	156 in•lb 17.6 N•m	116 in•lb 13.1 N•m	222 in•lb 25.1 N•m	167 in•lb 18.9 N•m	260 in•lb 29.4 N•m	195 in•lb 22 N•m
M8 X 1.25	225 in•lb 25.4 N•m	169 in•lb 19.1 N•m	333 in•lb 37.6 N•m	242 in•lb 31.3 N•m	377 in•lb 42.6 N•m	284 in•lb 32.1 N•m
M10 X 1.50	37 ft•lb 50.2 N•m	28 ft•lb 38 N•m	53 ft•lb 71.9 N•m	40 ft•lb 54.2 N•m	62 ft•lb 84.1 N•m	47 ft•lb 63.7 N•m
M12 X 1.75	65 ft•lb 88.1 N•m	49 ft•lb 66.4 N•m	93 ft•lb 126.1 N•m	69 ft•lb 93.6 N•m	108 ft•lb 146.4 N•m	81 ft•lb 109.8 N•m
M14 X 2.00	104 ft•lb 141 N•m	78 ft•lb 105.8 N•m	148 ft•lb 200.7 N•m	111 ft•lb 150.5 N•m	173 ft•lb 234.6 N•m	130 ft•lb 176.3 N•m
M16 X 2.00	161 ft•lb 218.3 N•m	121 ft•lb 164.1 N•m	230 ft•lb 311.8 N•m	172 ft•lb 233.2 N•m	269 ft•lb 364.7 N•m	202 ft•lb 273.9 N•m
M18 X 2.50	222 ft•lb 301 N•m	167 ft•lb 226.4 N•m	318 ft•lb 431.2 N•m	238 ft•lb 322.7 N•m	372 ft•lb 504.4 N•m	279 ft•lb 378.3 N•m
M20 X 2.50	314 ft•lb 425.7 N•m	235 ft•lb 318.6 N•m	449 ft•lb 608.8 N•m	337 ft•lb 456.9 N•m	525 ft•lb 711.8 N•m	394 ft•lb 534.2 N•m
M22 X 2.50	428 ft•lb 580.3 N•m	321 ft•lb 435.2 N•m	613 ft•lb 831.1 N•m	460 ft•lb 623.7 N•m	716 ft•lb 970.8 N•m	537 ft•lb 728.1 N•m
M24 X 3.00	543 ft•lb 736.2 N•m	407 ft•lb 551.8 N•m	776 ft•lb 1052.1 N•m	582 ft•lb 789.1 N•m	908 ft•lb 1231.1 N•m	681 ft•lb 923.3 N•m

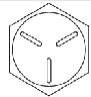

## SAE

SAE Bolt Torque						
Torque estimates based on clamp load (75% of proof strength) as specified in SAE J429 and ASME 574.						
Diameter and Thread Pitch	 <b>SAE Grade 5</b>		 <b>SAE Grade 8</b>		 <b>Socket Head Cap Screw</b>	
	Dry	Lubed	Dry	Lubed	Dry	Lubed
1/4-20	101 in•lb 11.4 N•m	76 in•lb 8.6 N•m	143 in•lb 16.2 N•m	107 in•lb 12.1 N•m	168 in•lb 19 N•m	120 in•lb 13.6 N•m
1/4-28	116 in•lb 13.1 N•m	87 in•lb 9.8 N•m	147 in•lb 16.6 N•m	123 in•lb 13.9 N•m	192 in•lb 21.7 N•m	144 in•lb 16.3 N•m
5/16-18	209 in•lb 23.6 N•m	157 in•lb 17.7 N•m	295 in•lb 33.3 N•m	221 in•lb 25 N•m	348 in•lb 39.3 N•m	264 in•lb 29.8 N•m
5/16-24	231 in•lb 26.1 N•m	174 in•lb 19.7 N•m	327 in•lb 36.9 N•m	245 in•lb 27.7 N•m	384 in•lb 43.4 N•m	288 in•lb 32.5 N•m
3/8-16	372 in•lb 42 N•m	276 in•lb 31.2 N•m	44 ft•lb 59.7 N•m	33 ft•lb 44.7 N•m	51 ft•lb 69.1 N•m	38 ft•lb 51.5 N•m
3/8-24	420 in•lb 47.5 N•m	312 in•lb 35.3 N•m	49 ft•lb 66.4 N•m	37 ft•lb 50.2 N•m	58 ft•lb 78.6 N•m	43 ft•lb 58.3 N•m
7/16-14	49 ft•lb 66.4 N•m	37 ft•lb 50.2 N•m	70 ft•lb 94.9 N•m	52 ft•lb 70.5 N•m	81 ft•lb 109.8 N•m	61 ft•lb 82.7 N•m
7/16-20	55 ft•lb 74.6 N•m	41 ft•lb 55.6 N•m	78 ft•lb 105.8 N•m	58 ft•lb 78.6 N•m	91 ft•lb 123.4 N•m	68 ft•lb 92.2 N•m
1/2-13	75 ft•lb 101.7 N•m	57 ft•lb 77.3 N•m	106 ft•lb 143.7 N•m	80 ft•lb 108.5 N•m	124 ft•lb 168.1 N•m	93 ft•lb 126.1 N•m
1/2-20	85 ft•lb 115.2 N•m	64 ft•lb 86.8 N•m	120 ft•lb 162.7 N•m	90 ft•lb 122 N•m	140 ft•lb 189.8 N•m	105 ft•lb 142.4 N•m
5/8-11	150 ft•lb 203.4 N•m	113 ft•lb 153.2 N•m	212 ft•lb 287.4 N•m	159 ft•lb 215.6 N•m	238 ft•lb 322.7 N•m	179 ft•lb 242.7 N•m
5/8-18	170 ft•lb 230.5 N•m	127 ft•lb 172.2 N•m	240 ft•lb 325.4 N•m	180 ft•lb 224 N•m	270 ft•lb 366.1 N•m	202 ft•lb 273.9 N•m
3/4-10	267 ft•lb 362 N•m	200 ft•lb 271.2 N•m	376 ft•lb 509.8 N•m	282 ft•lb 382.3 N•m	423 ft•lb 573.5 N•m	317 ft•lb 429.8 N•m
3/4-16	297 ft•lb 402.7 N•m	223 ft•lb 302.3 N•m	420 ft•lb 569.4 N•m	315 ft•lb 427.1 N•m	472 ft•lb 640 N•m	354 ft•lb 480 N•m
7/8-9	429 ft•lb 581.6 N•m	322 ft•lb 436.6 N•m	606 ft•lb 821.6 N•m	455 ft•lb 616.9 N•m	682 ft•lb 924.7 N•m	511 ft•lb 692.8 N•m
7/8-14	474 ft•lb 642.7 N•m	355 ft•lb 481.3 N•m	669 ft•lb 907 N•m	502 ft•lb 680.6 N•m	752 ft•lb 1019.6 N•m	564 ft•lb 791.8 N•m

## SECTION 2 GENERAL SAFETY INFORMATION

---

### Safety Symbols

Hazard alerts in this manual are used to alert operators, job supervisors, maintenance staff, and job-site workers to hazardous operating practices and maintenance procedures. Hazard alerts used throughout this manual contain a hazard-alert symbol and a signal word. They identify the hazard's degree of consequence if the message is ignored.

ANSI/ISO signal words are used to warn of potentially hazardous situations that may lead to damage, personal injury, or even death. Hazard alerts in this manual and on the machine use signal words or illustrations to indicate the potential level of hazard.

The following hazard alerts are used in this manual:



**DANGER** indicates a hazardous situation which, if not avoided, will result in death or serious injury.



**WARNING** indicates a hazardous situation which, if not avoided, could result in death or serious injury.



**CAUTION** indicates a hazardous situation which, if not avoided, could result in minor or moderate injury.



**NOTICE** is used to address practices not related to personal injury. Notice signs are typically used for activities that result in property damage.

### Implement Safety Guidelines



**Untrained people or failure to follow instructions can result in serious injury or death. Read all instructions before operating.**

Never allow untrained people to operate this implement. It is the owner's responsibility to get training and see to it that anyone who has permission to use your implement receives the proper training.

### Machine Decals

All safety decals on the implement must remain in place, intact, and visible. Make sure to have a good understanding of the decals prior to operating the machine. Become familiar with all the decal locations and their purposes.

**IMPORTANT: Decals should remain in the proper locations when being replaced.**

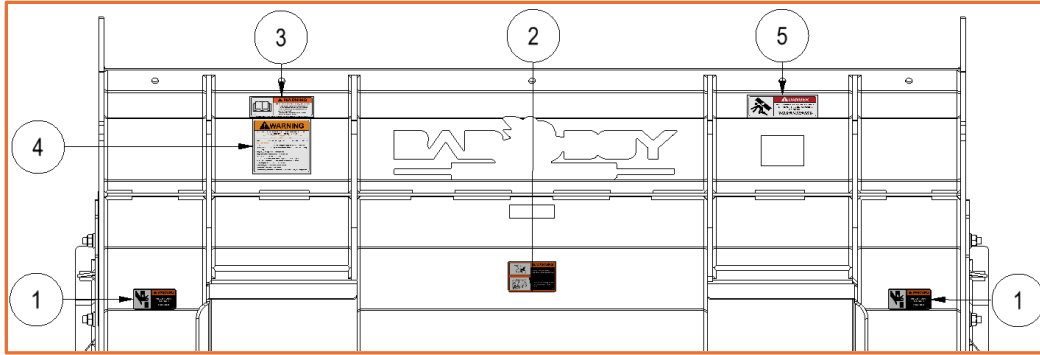

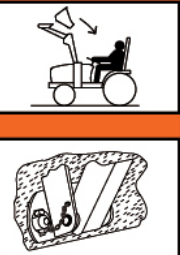



Figure 2-1

 <p><b>⚠ WARNING</b></p> <p><b>PINCH POINT HAZARD</b></p> <p>Keep clear</p> <p>101207</p>	<p><b>1) Implement Pinch Point Decal (PN 391-0032-00)</b> Warning: Read operators manual – General Safety</p> <p>2 Locations</p>
 <p><b>⚠ WARNING</b></p> <p>To avoid injury or death caused by falling attachment:</p> <ul style="list-style-type: none"> <li>Quick Attach locking levers must be engaged at all times.</li> </ul> <p>101208</p>	<p><b>2) Quick Attach Levers Warning Decal (PN: 391-0034-00)</b> Warning: Read operators manual – General Safety</p> <p>1 Location</p>
 <p><b>⚠ WARNING</b></p> <p>To Prevent Serious Injury or Death</p> <ul style="list-style-type: none"> <li>Avoid unsafe operation or maintenance.</li> <li>Do not operate or work on this machine without reading and understanding the Operator's Manual.</li> <li>If manual is lost, contact your nearest dealer for a new manual.</li> </ul> <p>101209</p> <p><b>⚠ WARNING:</b> Cancer and reproductive harm- www.P6SWarnings.ca.gov</p>	<p><b>3) Read Manual Decal (PN: 391-0037-00)</b> Warning: Read operators manual Hazard</p> <p>1 Location</p>
<p><b>⚠ WARNING</b></p> <p>FAILURE TO FOLLOW SAFETY AND OPERATING INSTRUCTIONS CAN LEAD TO SERIOUS INJURY OR DEATH.</p> <p>Si no lee Inglés, pida ayuda a alguien que pueda leerlo para que le explique las medidas de seguridad.</p> <ul style="list-style-type: none"> <li>Read operators manual BEFORE using machine. Contact your Bad Boy dealer or visit <a href="http://www.badboycountry.com">www.badboycountry.com</a> for manual.</li> <li>Lower equipment to the ground, turn off engine, engage brakes, remove key from ignition, and wait for all moving parts to come to a complete stop BEFORE servicing or adjusting.</li> <li>Keep away from equipment while in operation.</li> <li>Keep others away from equipment while in operation.</li> <li><b>NO RIDERS ALLOWED ON EQUIPMENT</b></li> <li>Inspect and maintain all guards and shields prior to operation of equipment.</li> <li><b>NEVER</b> allow children or unqualified persons to operate the equipment.</li> <li>Decrease speed around turns and uneven terrain.</li> <li>Never shake, hit, kick, or rock to dislodge material.</li> <li>DO not check for hydraulic leaks by hand.</li> <li>Prior to working underneath the implement secure or block up any lifted components.</li> </ul>	<p><b>4) General Warning Decal Non Rotating (PN: 391-0070-00)</b> Warning: Read operators manual – General Safety</p> <p>1 Location</p>
 <p><b>⚠ DANGER</b></p> <p><b>ROLL OVER CRUSHING HAZARD TO PREVENT SERIOUS INJURY OR DEATH</b></p> <p>REMOVE ATTACHMENT ON LEVEL GROUND AND STABILIZE UPON REMOVAL FROM LOADER</p>	<p><b>5) Roll Over Crush Hazard Decal (PN: 391-0071-00)</b> Danger: Roll Over Crushing Hazard</p> <p>1 Location</p>

## Personal Protective Equipment (PPE)

Operators must wear protective clothing and equipment appropriate for snow removal, which includes a hard hat, heavy-duty gloves, hearing protection, protective footwear, safety glasses or other approved eye protection, and a high-visibility safety vest. Proper PPE is essential to ensure safe and reliable operation of the Snow Pusher.



### Attention and Awareness

Safe operation requires the operator's full focus. Do not wear headphones or similar devices as a substitute for hearing protection. Headphones can block critical environmental sounds, reduce awareness of hazards, and increase the risk of accidents. Always use approved hearing protection that allows for environmental awareness when required.

## Operation Safety

### General Operation Safety



Failure to follow these general safety operation practices below can result in serious injury or death.

- Read, understand, and follow all instructions on the implement and in the manual before starting.
- Only allow responsible adults who are familiar with the instructions to operate the equipment.
- Never carry passengers.

### Preparation

- Check that all hardware is properly installed.
- Check the implement for any damaged pieces and replace them before operation begins.
- Always wear relatively tight and belted clothing to reduce the risk of clothing getting caught in the rotating power take-off (PTO) shaft and other moving parts.
- Make sure all safety decals are installed and free from damage. Replace if damaged.
- Make sure the implement is properly secured, adjusted, lubricated, and in good operating condition.
- Inspect guards before use. Replace if damaged. **DO NOT OPERATE** the implement without guards in place.
- The machine must be equipped with Roll-Over Protective Structure (ROPS) or ROPS cab and seat belt. **ALWAYS** keep seat belt securely fastened and remain seated. Keep fold-able ROPS system in 'locked up' position at all times.
- Keep hands, feet, hair, and clothing clear of all moving parts.
- Always wear the appropriate PPE when operating or servicing the implement.
- Do not operate the implement while under the influence of alcohol or drugs.
- Watch for traffic when operating near or crossing roadways.
- Never direct discharge toward people, animals, or property.
- Be alert of surroundings. Watch for rocks, stumps, mounds, depressions, and low hanging limbs or objects that could be potentially hazardous while removing snow.
- Remove accumulated debris from the implement and machine before and during use.
- A minimum of 20% of the machine and implement weight must be on the machine's front wheels when the implement is in transport position. Without this weight, the front wheels could raise up resulting in loss of steering. The weight may be attained with front wheel weights, ballasts in tires or front machine weights. Weigh the machine and implement, do not estimate.
- Do not exceed the lift capacity of the machine. See the machine specifications to verify load capacity.
- Always comply with state and local laws that may require additional markings, signage, or safety lights.

## Operation

Always sit in the machine's seat when operating controls or starting engine. Securely fasten seat belt, place transmission in neutral, engage brake, and ensure all other controls are disengaged before starting machine's engine.

- Do not operate the power take-off (PTO) during transport.
- Look down and to the rear and make sure area is clear of people, animals, property, or other objects before operating in reverse.
- Use extreme care and reduce ground speed on slopes and rough terrain.
- Watch for hidden hazards on the terrain during operation.
- Stop machine and implement immediately upon striking an obstruction. Turn off engine, remove key, inspect, and repair any damage before operation resumes.
- Leak down or failure of mechanical or hydraulic systems can cause implement to drop.
- Make certain all movements of implement components have stopped before exiting the machine.

## Slope Operation Safety

Slopes are a significant factor related to loss of control and tip-over accidents, which can result in severe injury or death. Operation on all slopes require extra caution. If you cannot back up the slope or if you feel uneasy on it, do not continue clearing snow.

- Do not operate or transport on steep slopes.
- Avoid starting, stopping or turning on a slope.
- Choose a low ground speed when operating the implement on a slope.
- Do not try to clear snow near drop-offs, ditches, or embankments.

## Children Safety

Extremely tragic accidents can, and do, occur if the operator is not continually alert to the presence of children. Children are often attracted to machinery and the operation of machinery. NEVER assume that children will remain where you last saw them.



**Never allow children to ride on or operate the machine. Be sure the area is clear of bystanders, pets, and especially children. Failure to follow these warnings could cause serious injury or death.**

- Keep children out of the machinery area and under the watchful care of a responsible adult other than the operator.
- This machine is capable of removing deep snow, which can obscure people, objects, and hazards. Always remain vigilant and continuously monitor the area ahead. Serious accidents have occurred when children or other persons were hidden from view by snow. The consequences are often tragic. Stay alert and maintain full awareness at all times during operation.
- Immediately turn the machine off if a child enters the area.
- Never allow children to operate the machine and implement (<16 years of age).
- Use extra care when approaching blind corners, shrubs, trees, or other objects that may block your view of a child.

## Service Safety



### General Service

- Before performing any service or maintenance, disconnect driveline from the machine power take-off (PTO).
- Before working underneath the implement raise, securely block, and disconnect the implement.
- Hydraulic system leak down and failure of mechanical or hydraulic system can cause implement to drop.
- Do not allow bystanders in the area when operating, attaching, removing, assembling, or servicing the implement.
- Keep all persons away from operator control area of the machine while performing adjustments, service, or maintenance.
- Do not modify or alter (or permit anyone else to modify or alter) the implement or any of its components in any way.
- Always wear relatively tight and belted clothing to avoid getting caught in moving parts. Wear sturdy, rough-soled work shoes and protective equipment for eyes, hair, hands, hearing, and head.
- Make certain all movement of implement components have stopped before approaching for service.
- Frequently check blades. They should be sharp, free of nicks and cracks, and securely fastened.
- Do not handle blades with bare hands. Always wear gloves. Careless or improper handling may result in serious injury.
- Your dealer can supply genuine replacement blades. Substitute blades may not meet original implement specifications and may be dangerous.

## SECTION 3 ASSEMBLY AND INSTALLATION

### Mounting

Your Bad Boy Snow Pusher comes standard with the quick attach system. This system will fit any Bad Boy tractor or machine fitted with a standard quick attach. To safely attach your implement to the machine, follow these steps:

1. Completely shut down machine and engage the parking brake.
2. Inspect the mount points for any debris or damage.
3. If needed, pull the locking handles on the quick attach until pins are fully raised. See Figure 3-1.
4. Return to the operator's seat and start the machine. Tip the quick attach forward away from the machine.
5. Slowly approach the implement centering yourself with the mount points. Make sure the quick attach is level with mount points.
6. Carefully place the top of the quick attach under the top of the mount points. See Figure 3-2.
7. Slowly lift the quick attach until the top of the quick attach and the top of the mount point have come together. See Figure 3-3.
8. Rotate the top of the quick attach toward the machine until the locking pins on the quick attach align with the slots on the mount points.
9. Shut down the machine and engage the parking brake.
10. Push the quick-attach lock handles down to secure the implement to the machine. Ensure the locking pins fully extend past the mounting plate and that the lock handles are fully engaged in the locked position.

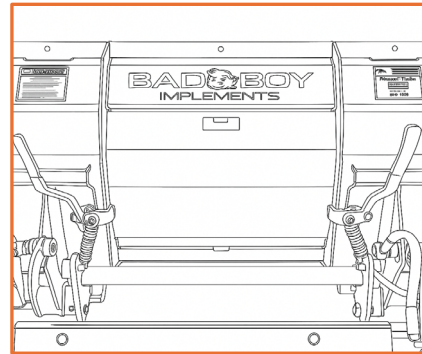

Figure 3-1

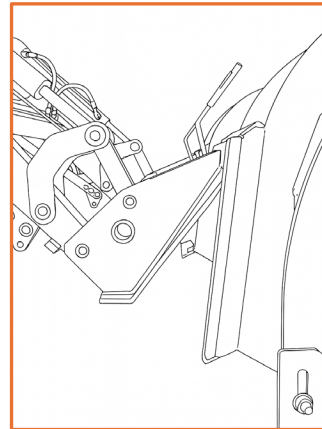

Figure 3-2

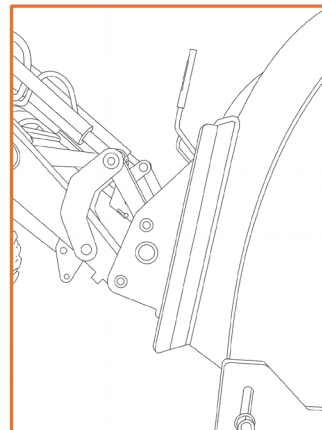

Figure 3-3

## Accessory Kit Installation

### Back Drag Assembly Kit

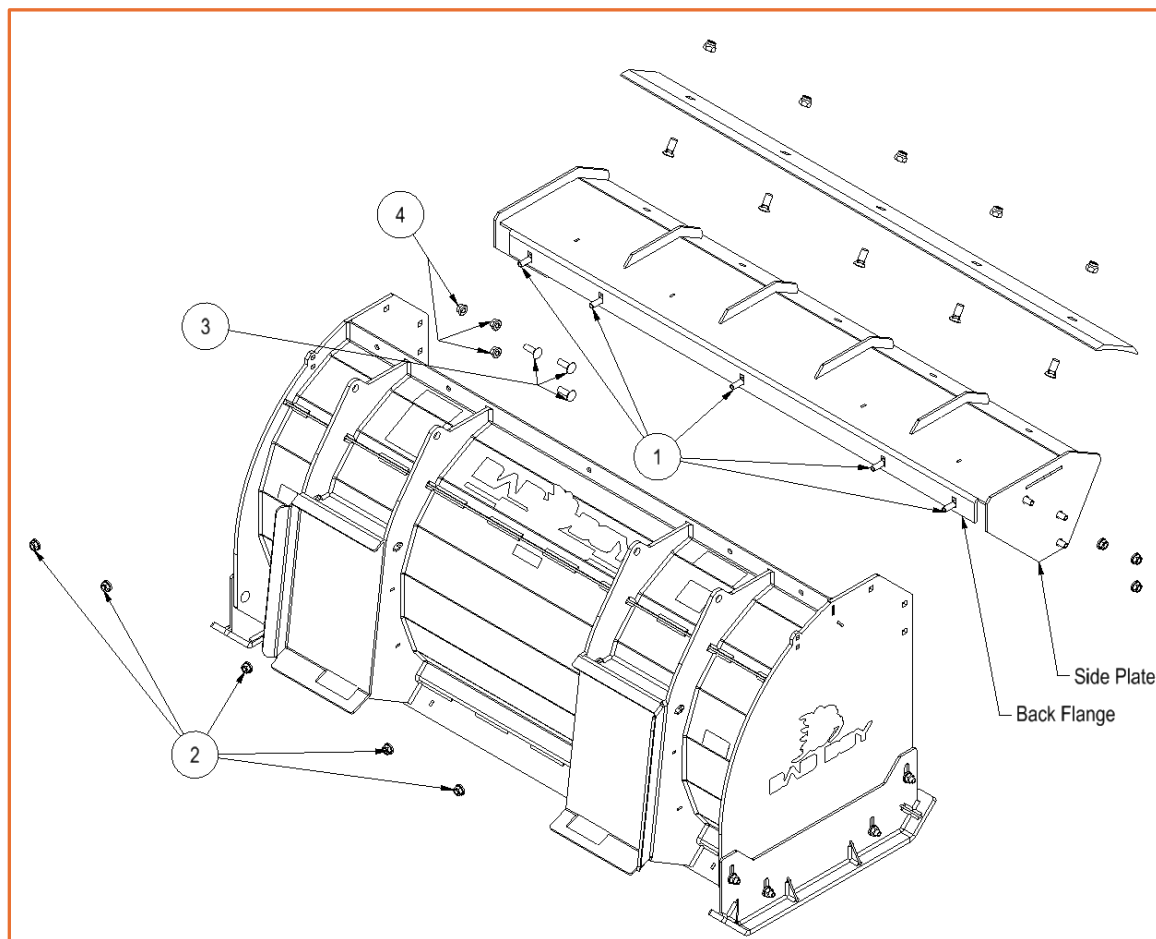

Figure 3-4

Follow the steps to install your Bad Boy Back Drag Assembly Kit. A 5' Snow Pusher is shown. Refer to Figure 3-5 for a close-up view.

1. Lift the back drag and set it on top of the Snow Pusher. Make sure side plates are on the outside of the implement, and the back flange is positioned inside the implement.
2. Place the provided bolts, 1/2-13 x 1-1/2" carriage bolt (1), through the back flange of the back drag and the Snow Pusher.
3. Hand tighten nuts (2) onto the bolts. **DO NOT FULLY TIGHTEN.**
4. Insert the provided bolts, 1/2-13 x 1-1/2" carriage bolt (3), into both sides of the Snow Pusher ensuring the bolts go all the way through the back drag.
5. Place nuts (4) on the bolts and firmly tighten using a wrench or socket.
6. Go back and tighten nuts from step 3.



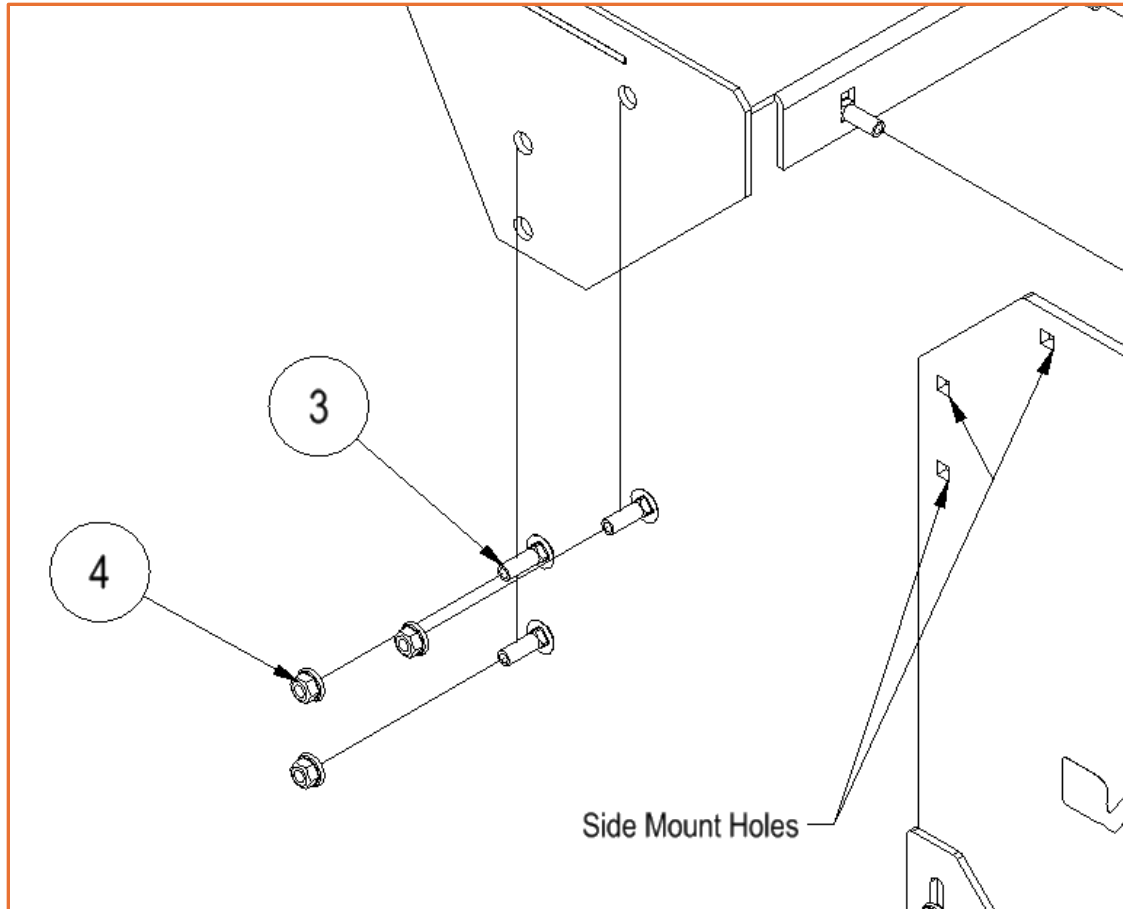

Figure 3-5 Close up view of Back Drag Assembly Kit.

## UHMW Skid Kit

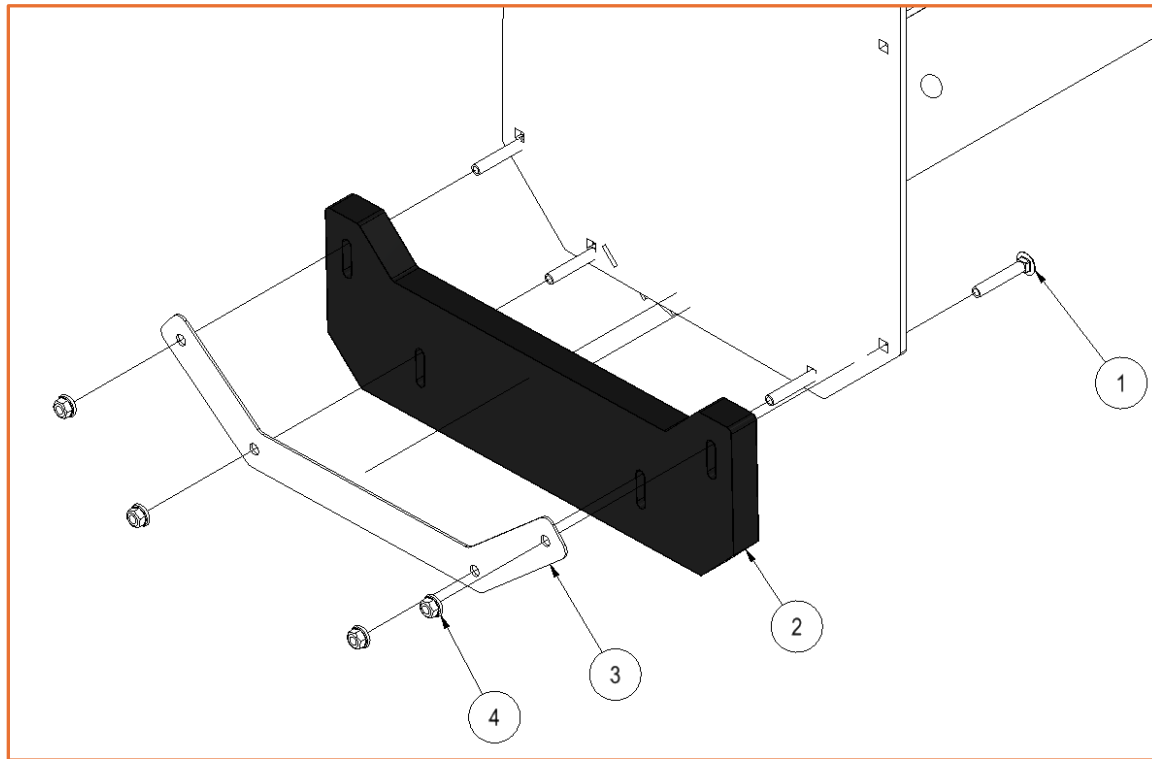

Figure 3-6

Follow the steps to install the UHMW Skid Kit.

1. Remove the nuts on the outside of the Snow Pusher that secure the metal skid shoe to the Snow Pusher. Refer to Figure 5-2 for a detailed view.
2. Remove the metal skids and bolts from the Snow Pusher.
3. Place the new bolts, 1/2-13 x 3" carriage bolts (1), into the slots on the Snow Pusher.
4. Slide the UHMW skids (2) onto the carriage bolts.
5. Slide the skid retainer (3) onto the bolts and push it up against the UHMW skid.
6. Place all four nuts (4) onto the bolts. Once all nuts are on tighten them.
7. Repeat steps 1-6 for the opposite side of the implement.

## UHMW Blade Kit

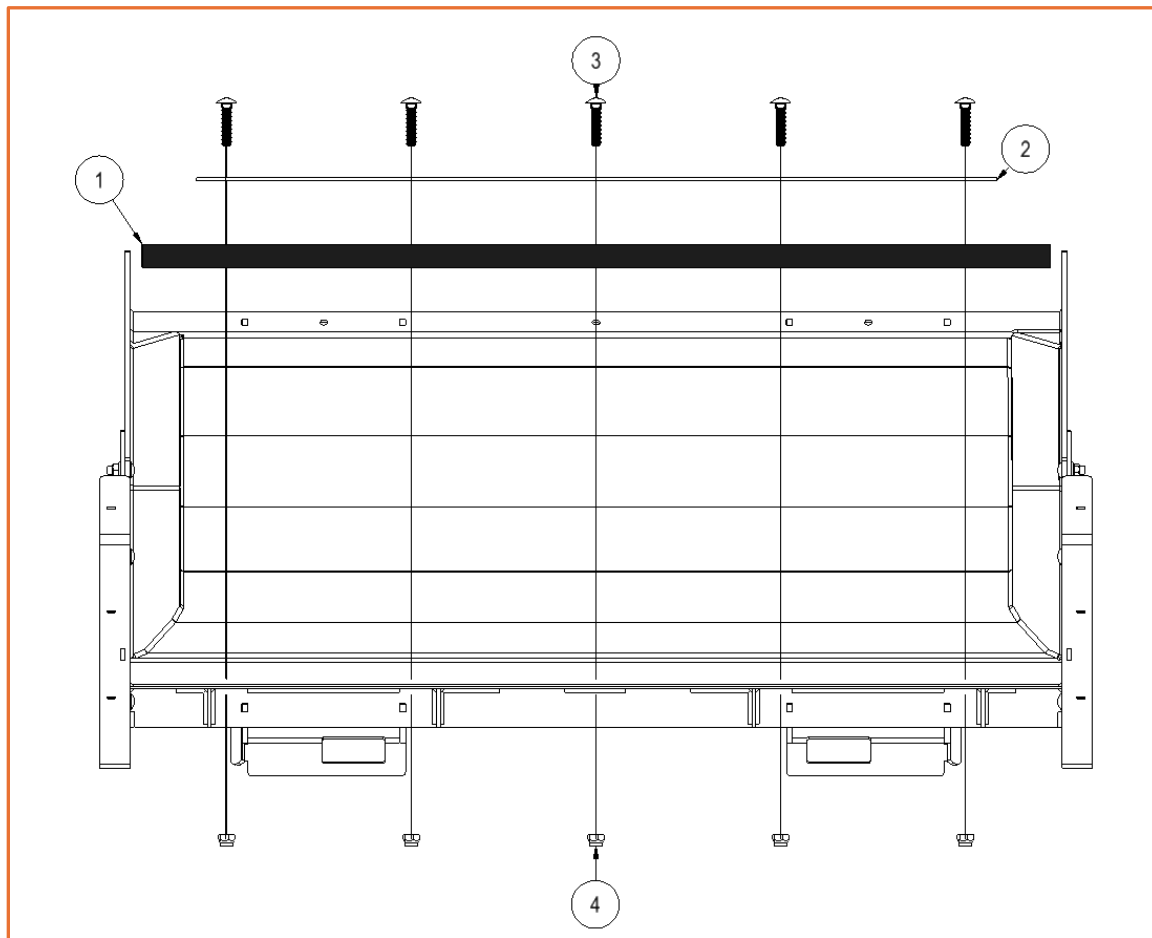

Figure 3-7: View of a 5' Snow Pusher from bottom side.

Follow the steps to install the UHMW Blade Kit.

1. Lift the implement and put blocks underneath both skids. Make sure the implement is secured and will not tip.
2. Remove the nuts from the backside of the existing metal blade. Refer to Figure 5-1 for a detailed view.
3. Once the nuts have been removed, pull the metal blade and bolts off the Snow Pusher.
4. Place the UHMW blade (1) and blade backer (2) on the moldboard.
5. Place the new bolts, 5/8-11 -2.75" carriage bolt (3), through the blade backer (2), UHMW blade (1), and moldboard.
6. Place the nuts (4) on the bolts and tighten them.
7. Remove the Snow Pusher from the blocks.

## SECTION 4 OPERATION

### Pre-Operation Checklist

#### **WARNING**

Failure to follow these machine operation instructions can cause serious injury or death.

- Read, understand, and follow all instructions on the implement and in the manual before starting.
- Never operate the implement with faulty parts. Replace or repair damaged parts and welds before operation.
- Do not apply excessive down pressure on the skid shoes. The weight of the implement provides the proper ground contact.
- Always wear a safety belt when clearing snow.

#### Mounting Points

- Inspect the mounting points on the back of the implement.
- Look for wear on the top and bottom plates of the mounts.
- Inspect all welds for damage.

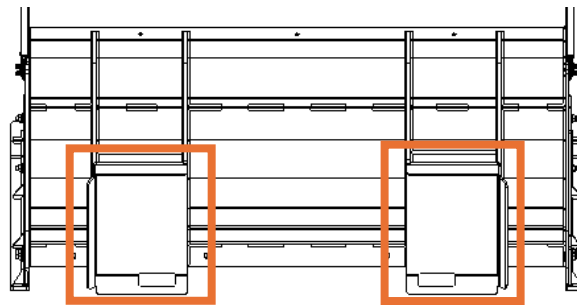

Figure 4-1

#### Blade

- Check the cutting edge of the blade to look for excessive wear, cracks, or any other damage.
- Check the mounting hardware to ensure all bolts are present and in suitable condition for operation.

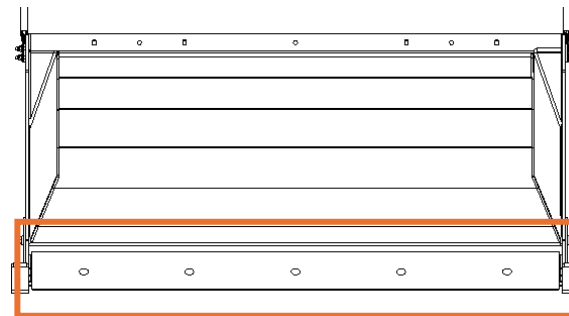

Figure 4-2

#### Metal Skid Shoes

- Inspect the skid shoes for any uneven or excessive wear.
- Inspect all bolts and welds for damage.

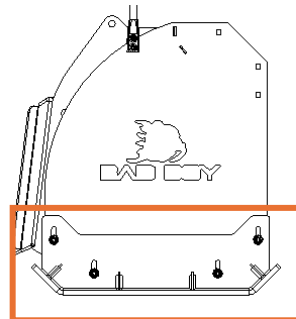

Figure 4-3

### Safety Decals

- Check all decals to make sure they are visible and legible.

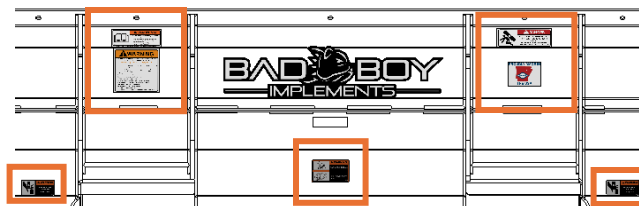

Figure 4-4

### Operation area

- Ensure that the area you intend to operate in is clear of all obstacles and bystanders.

## Operating Implement

Once the Bad Boy Snow Pusher has been properly mounted to the machine and tested, the implement is ready to begin operation. The Bad Boy Snow Pusher is designed for the sole purpose of snow removal. The use of this implement for anything other than snow removal is not condoned by Bad Boy Mowers, LLC.

### WARNING

**Failure to follow these instructions can cause serious injury or death.**

- Read, understand, and follow all instructions on the implement and in the manual before starting.
  - Never operate the implement with faulty parts.
  - Do not apply excessive down pressure on the skid shoes. The weight of the implement provides the proper ground contact.
  - Always wear a safety belt when clearing snow.
1. Owners must become familiar with the controls, ensuring how to raise, lower, tilt, and float the implement. Achieving the desired results will require a mixture of experimentation and experience with the implement.
  2. Make sure nothing is under or around the implement and the working area before beginning.
  3. Lower the snow pusher until it is parallel to the ground; do not tilt excessively forward or backward.
  4. Gently lower the implement until the skid shoes rest evenly on the surface.
  5. Begin moving at a slow pace to allow tires or tracks to gain traction before accelerating.
  6. Maintain a consistent speed to ensure even clearing.

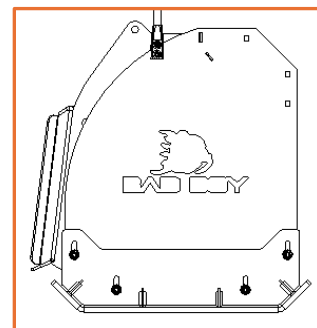

Figure 4-5

## Back Drag Kit

1. Tilt the Snow Pusher forward, away from the machine, until the lower edge is parallel to the ground.
2. Lower the implement until the cutting edge of the back drag blade hovers just above the snow.
3. Approach the obstruction slowly and cautiously, stopping a safe distance away to prevent damage.
4. Lower the back drag until the cutting edge of the blade rests lightly on the surface.
5. Slowly reverse the machine, pulling snow away from the obstruction until it is far enough to be collected with normal forward pushing.

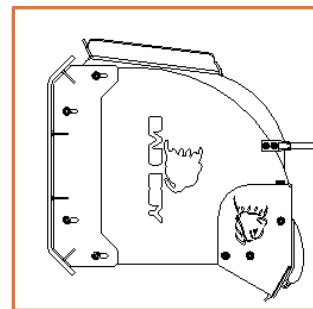

Figure 4-6

## Tips

Clearing snow requires a safe manageable speed no greater than 10mph. Faster speeds may blow snow onto the windshield reducing visibility. Hitting obstructions at excessive speeds can lead to serious bodily harm, damage to the implement, or damage to the machine. The ideal speed to operate depends on several factors: snow depth, water content, and area of operation.

- Recommended operating speed is 2–5 mph (3–8 km/h) depending on snow depth, ground conditions, and operator experience. Operating too fast can cause loss of control, reduced clearing efficiency, or implement damage.
- Reduce speed as you approach the end of the clearing area and raise the implement gradually to prevent scraping and assist with snow stacking.
- When available, operate in the machine's float mode. Float mode allows the Snow Pusher to follow ground contours automatically without applying constant down pressure—this prevents gouging the surface and reduces wear on skid shoes and hydraulic cylinders.
- Before snowfall, mark the perimeter of the clearing area and identify hazards such as curbs, drains, obstacles, or uneven ground using stakes or flags.
- Plan your clearing pattern in advance, especially in tight or confined areas.
- Remove snow early, before it becomes wet and heavy. Wet or deep snow increases load on both the Snow Pusher and the machine.
- Let snow depth and moisture content determine your clearing width. Make each pass wide enough for efficient removal without overloading the implement and machine.
- If heavy snowfall is expected, clear periodically during the storm to prevent excessive accumulation. Deep snow may require multiple passes, gradually lowering the implement with each pass until the area is fully cleared.
- Keep drains and water outlets clear throughout the season to allow meltwater to drain and prevent refreezing.
- Do not stack snow near roadways where it may obstruct visibility for drivers or pedestrians.
- Use extreme caution when operating near parked vehicles, buildings, or other obstacles. Push or pull snow away from structures before clearing the surrounding area.
- When possible, perform snow removal during low-traffic periods to reduce risk and improve efficiency.
- Stay alert to vehicles, people, and other hazards within the operating area at all times.

# SECTION 5 MAINTENANCE

---

## Routine Maintenance

Implement maintenance must be done at regular intervals. Failure to do so will result in excessively worn parts and early failures.

**Note: Always perform maintenance with the Snow Pusher lowered, engine off, and proper safety procedures followed.**

Before Each Use:

- Perform the pre-operation inspection (page 4-19).

Weekly:

- Clean the Snow Pusher thoroughly. Make sure all debris and salt buildup are removed.
- Check mounting points and verify alignment. Ensure that there are no deformations or cracks in the mount points.

Seasonal or After Heavy Use:

- Perform a thorough inspection of the entire implement for fatigue or damage.
- Retorque all fasteners.
- Inspect wear components. Adjust or replace if necessary.

## Rotating Metal Blade

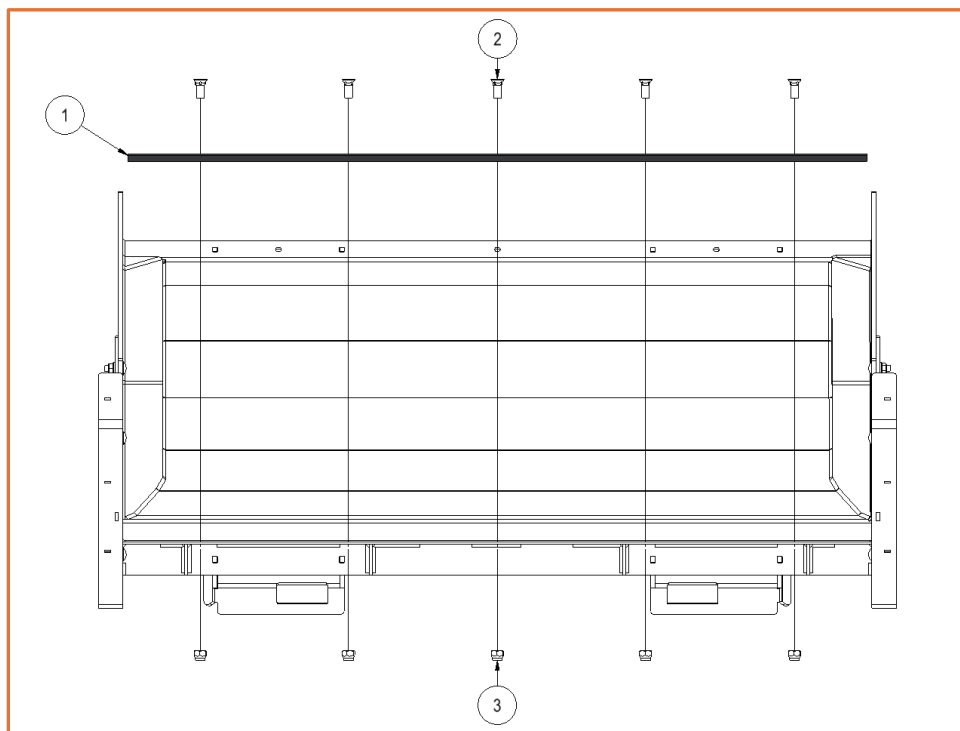

Figure 5-1 View from the bottom.

Follow the steps to rotate the Snow Pusher Metal Blade. A 5' Snow Pusher is shown.

1. Lift the implement and put blocks underneath both skids. Make sure the implement is secured and will not tip.
2. Remove the nuts (3) from the backside of the blade.
3. Pull the blade (1) and bolts (2) off the Snow Pusher.
4. Place bolts and nuts in a safe space to be reinstalled.
5. Rotate the blade (1) to the unworn edge and place it on the moldboard.
6. Place the bolts (2) through the blade and moldboard.
7. Place the nuts (3) on the bolts and tighten them.
8. Remove the Snow Pusher from the blocks.

## Rotating UHMW Blade

Follow the steps to rotate the Snow Pusher UHMW Blade. Refer to Figure 3-7 for a detailed view.

1. Lift the implement and put blocks underneath both skids. Make sure the implement is secured and will not tip.
2. Remove the nuts (4) from the backside of the blade backer (2) and UHMW blade (1).
3. Once the nuts have been removed pull the bolts (3), blade backer (2), and UHMW blade (1) off the Snow Pusher.
4. Place bolts and nuts in a safe space to be reinstalled.
5. Rotate the UHMW blade (1) to the unworn edge and place it on the moldboard.
6. Place the blade backer (2) on top of the UHMW blade (1).
7. Place the bolts (3) through the blade backer (2), UHMW blade (1), and moldboard.
8. Place the nuts (4) on the bolts and tighten them.
9. Remove the Snow Pusher from the blocks.



## Replacement Parts List

Please refer to Section 7, page 7-31, for a complete list of parts for the implements and kits.

## Replacing Worn Components

For information on inspecting worn components refer to the Pre-Operation Checklist on page 4-19 for a complete step by step.

### Metal Skid Shoes

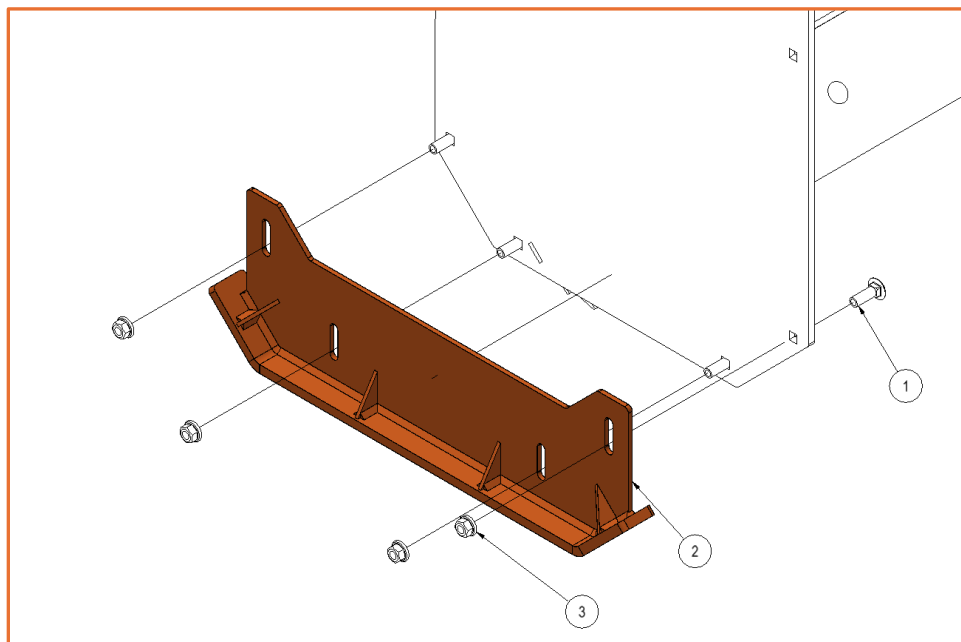

Figure 5-2

Follow the steps to replace your Bad Boy Metal Skid Shoes.

1. Remove the nuts on the outside of the Snow Pusher that secure the skid shoe to the Snow Pusher.
2. Remove the old metal skid shoe from the Snow Pusher leaving the carriage bolts (1) in place.
3. Place the new metal skid shoe (2) onto the carriage bolts left in step 2.
4. Place nuts (3) on carriage bolts and hand-tighten the nuts. **DO NOT FULLY TIGHTEN**
5. Adjust the skid shoe to the desired height.
6. Once the skid shoe is in the desired position, tighten all the nuts.
7. Repeat steps 1 through 6 for the opposite side of the implement.

## Metal Blade

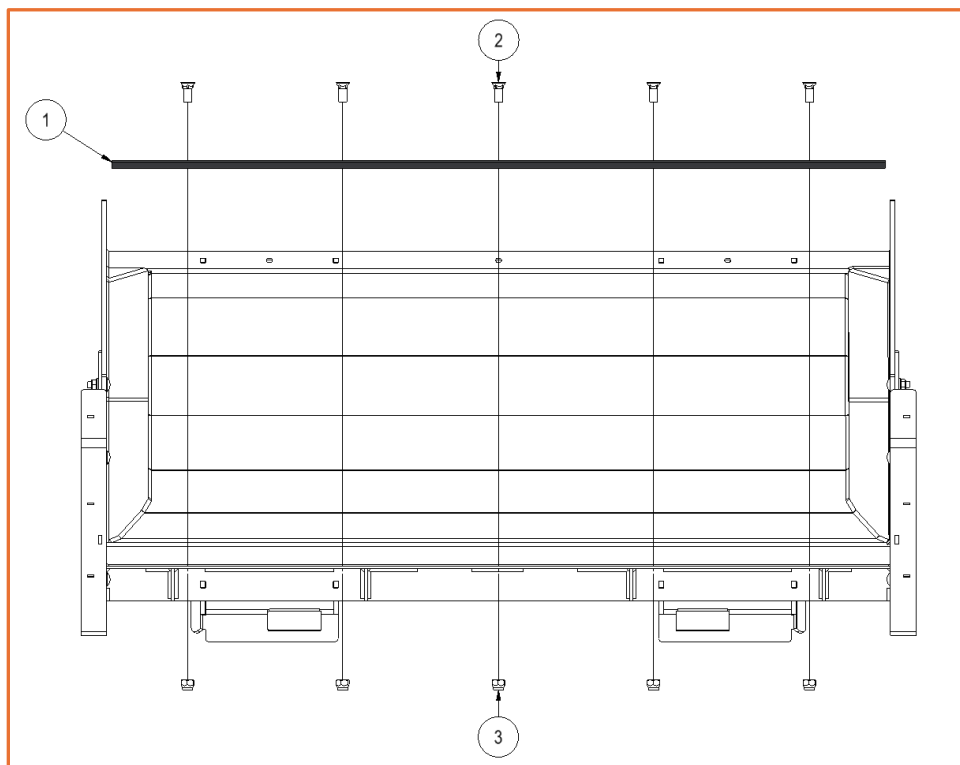

Figure 5-3 View from the bottom.

Follow the steps to replace the Snow Pusher Metal Blade. A 5' Snow Pusher is shown:

1. Lift the implement and put blocks underneath both skids. Make sure the implement is secured and will not tip.
2. Remove the nuts (3) from the backside of the existing blade.
3. Pull the blade and bolts off the Snow Pusher.
4. Place bolts and nuts in a safe space to be reinstalled.
5. Place the new blade (1) on the moldboard.
6. Place the bolts (2) through the blade and through the moldboard.
7. Place the nuts (3) on the bolts and tighten them.
8. Remove the Snow Pusher from the blocks.

## Replacing Decals

To replace damaged or faded safety decals follow the steps below. Please contact your local Bad Boy dealer to order new decals. To find a Bad Boy dealer visit FIND A DEALER at [www.badboycountry.com](http://www.badboycountry.com).

1. Clean the area where the label will be placed with soapy water.
2. Spray soapy water on the area where the label will be placed.
3. Peel backing from the label and press the label against the wet surface.
4. Smooth out any air bubbles using a straight edge like a ruler or credit card to create the adhesion to the implement.

## Troubleshooting

Problem	Cause	Solution
Cutting edge digging into surface	Soft surface	Change to Bad Boy UHMW blade
	Skid shoes set too high	Adjust skid shoes
Excessive wear on cutting edge of blade	Excessive down pressure	Limit use of float and manually control down pressure.
	Blade tipped too far	Tip the Snow Pusher back to ride on skid shoes
The Snow Pusher leaves behind snow	Worn out cutting edge on the blade	Adjust or replace blade
	The Snow Pusher is tilted too far forward	Adjust the angle of the Snow Pusher
The Snow Pusher does not seat properly on machine	Quick attach not fully retracted before attachment	Retract quick attach before attaching
	Debris built up in mounting points or on quick attach	Clean the Snow Pusher mounts and quick attach

## Long-Term Storage

- Wash the Snow Pusher thoroughly with a pressure washer or water hose. Be sure to wash off all mud, salt, or other debris.
- Remove any remaining debris and wipe down the Snow Pusher with a dry towel.
- Perform any necessary maintenance in preparation for next season.
- Inspect the Snow Pusher for damaged or worn parts. Replace damaged parts.
- Replace any missing safety decals.
- Touch up any spots with chipped or scraped paint to prevent rust.
- It is best to store the Snow Pusher in a dry, clean area off the ground or floor on blocks.
- For outside storage cover the Snow Pusher with a large waterproof tarp and secure it to the Snow Pusher. The Snow Pusher should be off the ground on blocks or skids.

## Maintenance Log

<b>Date:</b>	<b>Performed:</b>
<b>Date:</b>	<b>Performed:</b>
<b>Date:</b>	<b>Performed:</b>
<b>Date:</b>	<b>Performed:</b>
<b>Date:</b>	<b>Performed:</b>
<b>Date:</b>	<b>Performed:</b>
<b>Date:</b>	<b>Performed:</b>
<b>Date:</b>	<b>Performed:</b>
<b>Date:</b>	<b>Performed:</b>
<b>Date:</b>	<b>Performed:</b>
<b>Date:</b>	<b>Performed:</b>
<b>Date:</b>	<b>Performed:</b>
<b>Date:</b>	<b>Performed:</b>
<b>Date:</b>	<b>Performed:</b>
<b>Date:</b>	<b>Performed:</b>

## SECTION 6 LIMITED WARRANTY

---

1. WHAT THIS WARRANTY COVERS, AND FOR HOW LONG:

Bad Boy Mowers, LLC will, at its option, repair or replace without charge, any part covered by the warranty which is found to be defective in material and/or workmanship for one (1) year\* after the date of sale to the original retail purchaser **unless the product is used for rental purposes, in which case there is no warranty.**

At Bad Boy Mowers, LLC's request, customer will make the defective part available for inspection by Bad Boy Mowers, LLC and/or return the defective part to Bad Boy Mowers, LLC, with **transportation charges prepaid.**

2. WHAT THIS WARRANTY DOES NOT COVER:

- A. This warranty does not cover defects caused by depreciation or damage caused by normal wear, accidents, improper maintenance, improper use or abuse of the product, alterations, or failure to follow the instructions contained in the Owner's Manual for operation and maintenance.
- B. The customer shall pay any charges for making service calls and/or for transporting the Implement to and from the place where the inspection and/or warranty work is performed. Bad Boy Mowers, LLC will not be responsible for the pickup and delivery of an Implement for warranty purposes.
- C. Normal maintenance services, normal deterioration of exterior finish due to use or exposure, and normal deterioration of consumable wear items such as the UHMW skid shoes and blades.
- D. Replacement of services and items are subject to normal service replacement.

3. HOW TO OBTAIN SERVICE UNDER THIS WARRANTY:

- A. Warranty service can be arranged by contacting the dealer where you purchased the implement or by sending an email to [warranty@badboycountry.com](mailto:warranty@badboycountry.com). Proof of the date of purchase may be required to verify warranty coverage. Warranty repairs must be completed by an authorized Bad Boy center.
- B. Warranty claims will not be reviewed or paid unless the warranty registration is received by Bad Boy Mowers, LLC within 30 days of the retail purchase date.
- C. Warranty claims requiring parts returned will be settled upon return of parts to Bad Boy for inspection.
- D. All warranty issues must be handled through an authorized service center or dealership.

4. WARRANTY LIMITATION:

- A. THERE IS NO OTHER EXPRESS WARRANTY. ANY WARRANTY THAT MAY BE IMPLIED FROM THIS PURCHASE, INCLUDING MERCHANTABILITY AND FITNESS FOR A PARTICULAR PURPOSE IS HEREBY LIMITED TO THE DURATION OF THIS WARRANTY AND TO THE EXTENT PERMITTED BY LAW. ANY AND ALL IMPLIED WARRANTIES ARE EXCLUDED. Some states do not allow limitations on how long an implied warranty lasts, so the above limitations may not apply to you.

- B. BAD BOY MOWERS, LLC WILL NOT BE LIABLE FOR ANY INCIDENTAL, CONSEQUENTIAL, OR SPECIAL DAMAGES AND/OR EXPENSES IN CONNECTION WITH THE PURCHASE OR USE OF THE IMPLEMENT. Some states do not allow the exclusion or limitation of incidental or consequential damages, so the above limitation(s) or exclusion(s) may not apply to you

- C. Only the warranty expressed in this limited warranty shall apply and no dealer, distributor, or individual is authorized to amend, modify, or extend this warranty in any way. Accordingly, additional statements such as dealer advertising or presentations, whether oral or written, do not constitute warranties by Bad Boy Mowers, LLC and should not be relied on.
- D. This warranty extends only to equipment operated under normal conditions and properly serviced and maintained. The warranty expressly does not cover (i) any defects, damage, or

---

deterioration due to normal use, wear and tear, or exposure; (ii) normal maintenance services; (iii) damage or defects arising out of or relating to misuse, neglect, alteration, negligence, or accident; (v) repair or replacement arising from operation of or use of the equipment which is not in accordance with operating instructions as specified in the Operator's Manual or other operational instructions provided by Bad Boy Mowers, LLC; (vi) repair or replacement arising as a result of any operation from equipment that has been altered or modified so as to, indetermination of Bad Boy Mowers, LLC, adversely affect the operation, performance, or durability of the equipment or that has altered, modified, or affected the equipment so as to change the intended use of the product; (vii) repair or replacement necessitated by use of parts, accessories, or supplies, including gasoline, oil, or lubricants that are incompatible with the equipment or other than as recommended in the Operator's Manual or other operational instructions provided by Bad Boy Mowers, LLC; (viii) repairs or replacements resulting from parts or accessories which have adversely affected the operation, performance, or durability of the equipment; or (ix) damage or defects due to or arising out of repair of equipment by person or persons other than an authorized Bad Boy Mowers, LLC service dealer or the installation of parts other than genuine Bad Boy Mowers, LLC recommended parts. As a condition to this warranty, customer shall have read the Operator's Manual and ensured the Implement has been registered within 30 days of purchase.

- E. This warranty gives you specific legal rights, and you may also have other rights, which vary from state to state.

---

BAD BOY MOWERS, LLC  
102 INDUSTRIAL DRIVE  
BATESVILLE, AR 72501  
**WWW.BADBOYCOUNTRY.COM**

Technical Support: .....techsupport@badboycountry.com  
Warranty:.....warranty@badboycountry.com  
Parts:.....partsdept@badboycountry.com

## Warranty Registration

**Ensure selling dealership has registered the Implement within 30 days of purchase to validate warranty. Please record the serial number, date of purchase, and dealership information for your records.**

Serial # \_\_\_\_\_

Date of Purchase \_\_\_\_\_

Dealer Information \_\_\_\_\_

## SECTION 7 PARTS

### Quick Reference Chart

PART NUMBER	DESCRIPTION
013-0010-00	1/2-13 Mechanical Lock Nut Grade F
013-5041-00	3/8-16 Nylon Insert Locknut Zi
018-0008-00	1/2 x 1 1/2 Carriage Bolt
018-4706-00	3/8 x 1 1/2 Carriage Bolt
019-8044-00	5/16 USS Flat Washer Zinc
313-0002-00	5/8 Nylock Nut
318-5020-00	5/8-11 x 1-1/2 #3 Flat HD Plow Bolt
335-0004-00	36" Snow Pusher Blade Marker
338-0007-00	60" Box Blade
388-0014-01	5' Back Drag Weldment--Orange
388-3060-01	Snow Pusher Skid Weldment--Orange
388-3061-07	5' Snow Pusher Main Weldment--Black
391-0032-00	Grapple Pinch Point Decal
391-0037-00	Pallet Fork Manual Decal
391-0040-00	Made In USA Decal
391-0062-00	Blank Serial Decal
391-0069-00	Implements Logo Decal
391-0070-00	Snow Pusher Warning Decal
391-0071-00	Snow Pusher Roll Over Crush Hazard Decal
018-0067-00	1/2-13 x 3 Carriage Bolt Grade 5
039-0572-00	UHMW Skid Retainer Bracket--Orange
318-0053-00	5/8-11 x 2 3/4 Carriage Bolt Zinc GR 5
326-0236-07	5' UHMW Blade Backer--Black
338-0038-00	Snow Pusher Skid-Black
338-0040-00	5' Snow Pusher UHMW Blade--Black
338-0005-00	72" Box Blade
388-3059-07	6' Snow Pusher Main Weldment--Black
388-0012-01	6' Back Drag Weldment--Orange
326-0237-07	6' UHMW Blade Backer--Black
338-0039-00	6' Snow Pusher UHMW Blade--Black
326-0238-07	7' UHMW Blade Backer--Black
335-0005-00	48" Snow Pusher Blade Marker
338-0041-00	7' Snow Pusher UHMW Blade--Black
388-0016-01	7' Back Drag Weldment--Orange
388-0018-07	7' Snow Pusher Main Weldment--Black
338-0009-00	84" Box Blade



## PARTS SECTION: 5' Snow Pusher (BBSP60)

SKUs:

BBSP60O BBSP60BDO BBSP60UHO BBSP60UHBDO  
BBSP60BK BBSP60BDBK BBSP60UHBK BBSP60UHBDBK

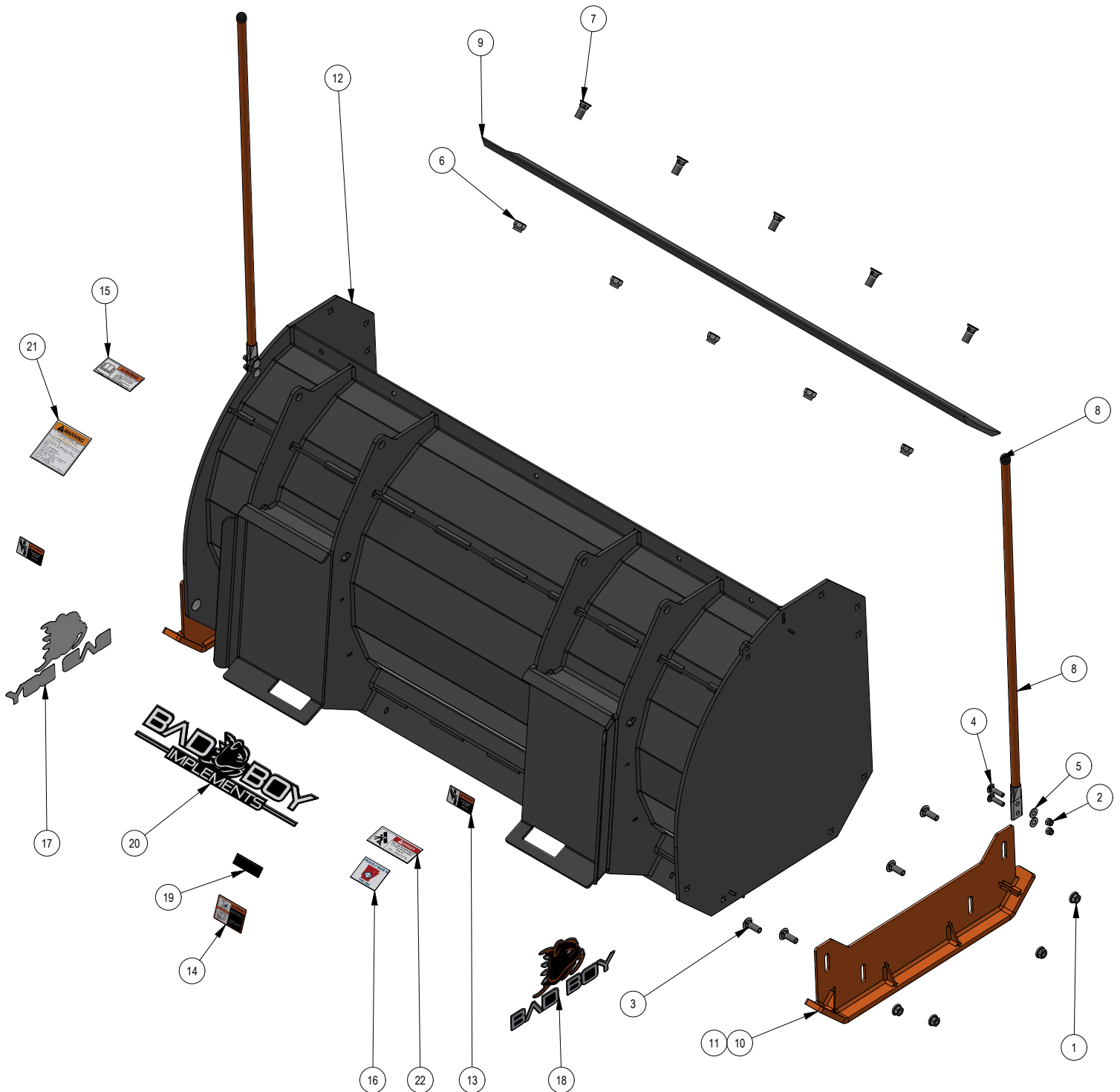

## PARTS SECTION: 5' Snow Pusher (BBSP60)

Parts List			
ITEM	QTY	PART NUMBER	DESCRIPTION
1	8	013-0010-00	1/2-13 HEX FLANGE AUTO OVAL LOCKNUT (GR.F) ZINC/WAX
2	4	013-5041-00	3/8-16 NYLON INSERT LOCKNUT ZINC
3	8	018-0008-00	1/2-13 X 1-1/2 CARRIAGE BOLT (GR.5) ZINC
4	4	018-4706-00	3/8-16 X 1-1/2 CARRIAGE BOLT ZINC
5	4	019-8044-00	5/16 USS FLAT WASHER (7/8 OD) ZINC
6	5	313-0002-00	5/8-11 NYL INS L/N ZC
7	5	318-5020-00	No.3 Round Regular Head Countersunk Square Neck Plow Bolt - UNC BB
8	2	335-0004-00	36' Snow Pusher Blade Marker
9	1	338-0007-00	60" LG/BB blade
10	2	388-3060-00	snow pusher skid weldment
11	2	388-3060-07	Snow Pusher Skid Weldment - Black
12	1	388-3061-00	5 Ft Snow Pusher Weldment
13	2	391-0032-00	Implement Pinch Point Decal
14	1	391-0034-00	Quick Attach Levers Warning Decal
15	1	391-0037-00	Read Manual Decal
16	1	391-0040-00	Made in the USA
17	1	391-0059-00	Tiller/Box Cutter Bad Boy Left Decal 12.94"
18	1	391-0060-00	Tiller/Box Cutter Bad Boy Right Decal 12.94"
19	1	391-0062-00	Black 1.25"x4.25"
20	1	391-0069-00	Implements Logo Decal
21	1	391-0070-00	General Warning Decal Non Rotating
22	1	391-0071-00	Roll Over Crush Hazard Decal

## PARTS SECTION: 5' Back Drag Kit

Kit Part Number:

388-0015-01 - Orange

388-0015-07 - Black

Parts List			
ITEM	QTY	PART NUMBER	DESCRIPTION
1	11	013-0010-00	1/2-13 HEX FLANGE AUTO OVAL LOCKNUT (GR.F) ZINC/WAX
2	11	018-0008-00	1/2-13 X 1-1/2 CARRIAGE BOLT (GR.5) ZINC
3	5	313-0002-00	5/8-11 NYL INS L/N ZC
4	5	318-5020-00	No.3 Round Regular Head Countersunk Square Neck Plow Bolt - UNC BB
5	1	338-0007-00	60" LG/BB blade
6	1	388-0014-00	5ft Snow Pusher Backdrag Weldment
7	1	388-0014-07	5ft Snow Pusher Backdrag Weldment - Black

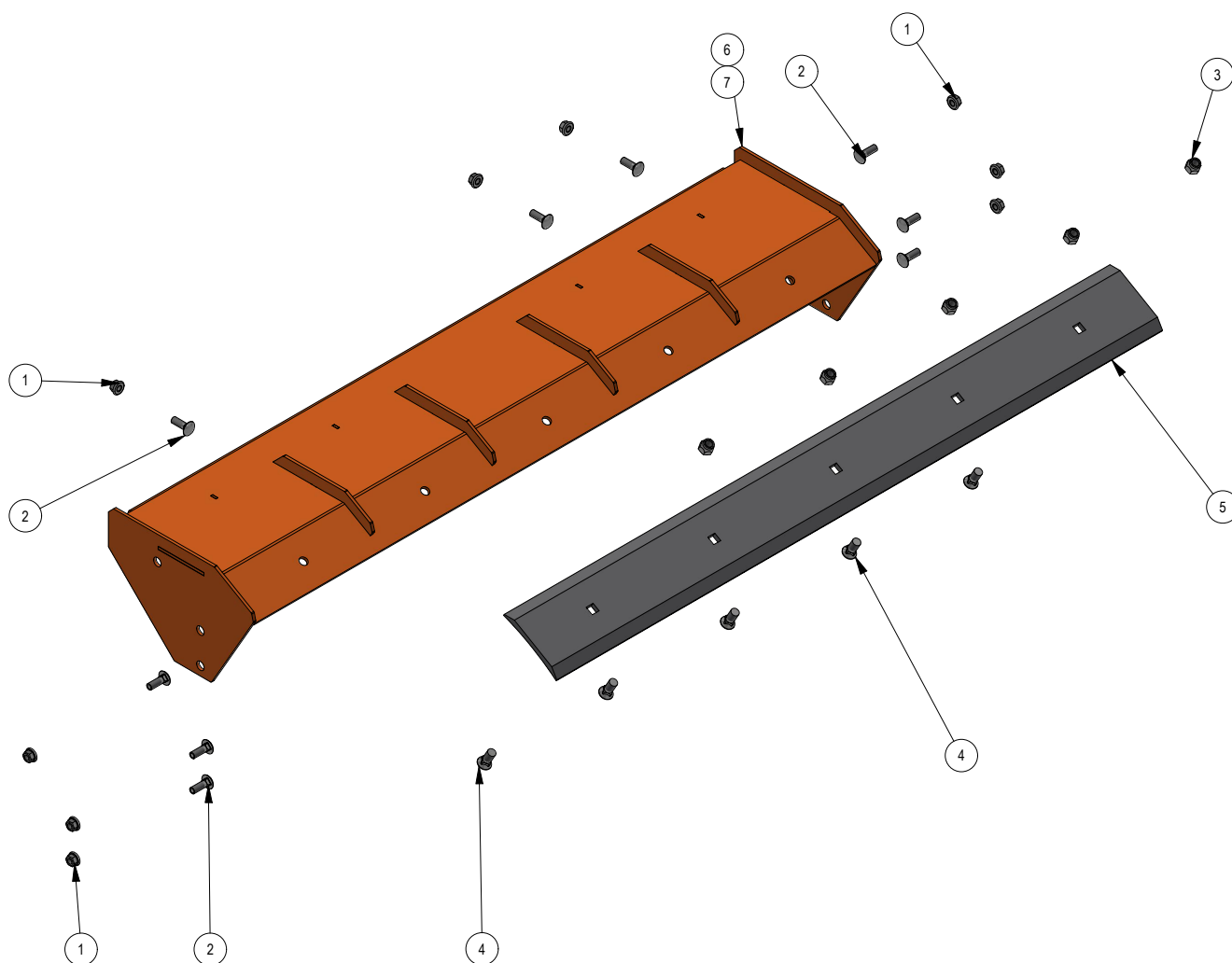

## PARTS SECTION: 5' UHMW Back Drag Kit

Kit Part Number:

388-0025-01 - Orange

388-0025-07 - Black

Parts List			
ITEM	QTY	PART NUMBER	DESCRIPTION
1	11	013-0010-00	1/2-13 HEX FLANGE AUTO OVAL LOCKNUT (GR.F) ZINC/WAX
2	11	018-0008-00	1/2-13 X 1-1/2 CARRIAGE BOLT (GR.5) ZINC
3	5	313-0002-00	5/8-11 NYL INS L/N ZC
4	5	318-0053-00	5/8-11 x 2 3/4 Carriage Bolt Zinc GR 5
5	1	326-0236-01	5' UHMW Blade Backer- Orange
6	1	338-0040-00	5 FT UHMW Blade
7	1	388-0014-00	5ft Snow Pusher Backdrag Weldment
8	1	388-0014-07	5ft Snow Pusher Backdrag Weldment - Black

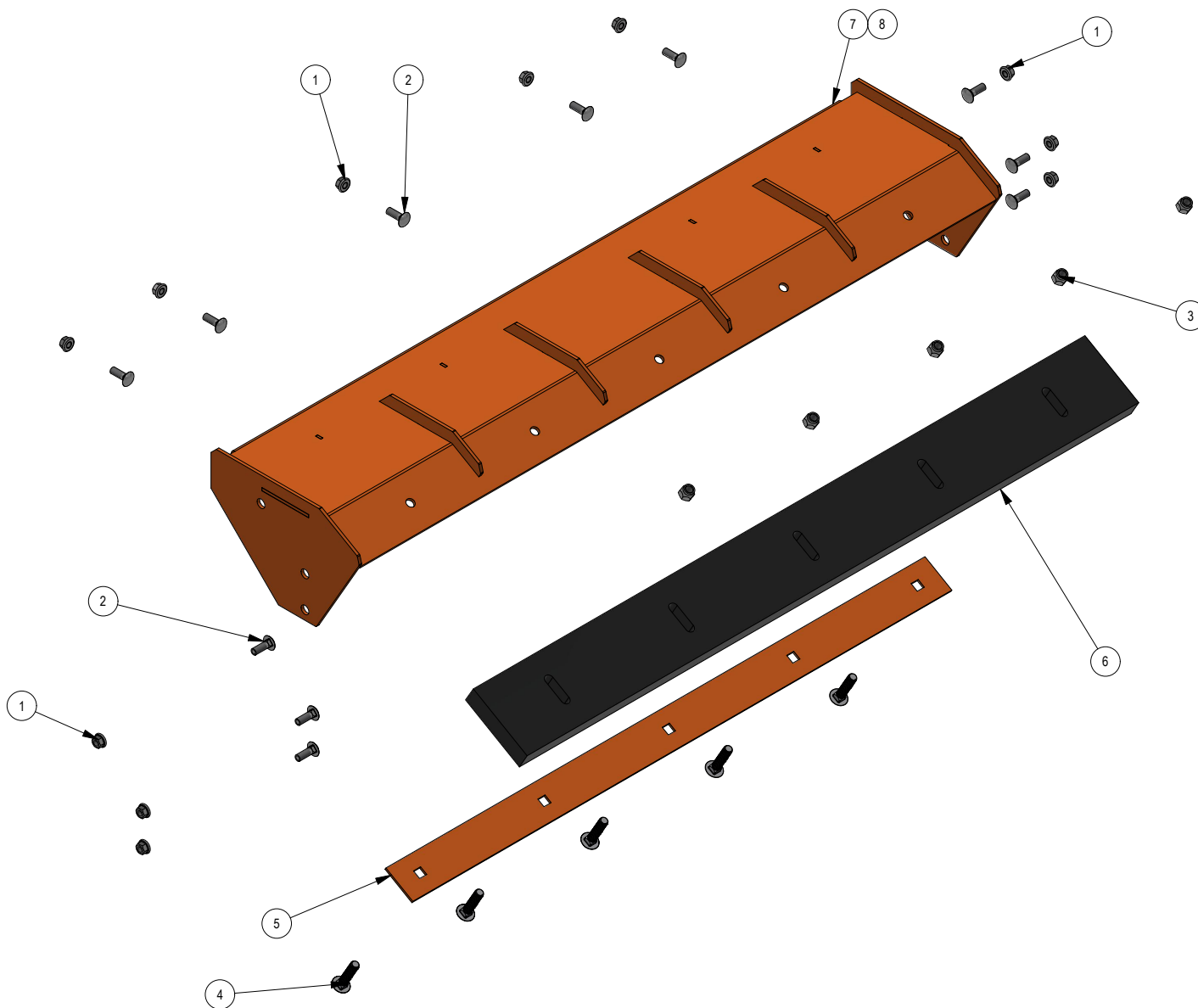

PARTS SECTION: 5' UHMW Blade Kit

Kit Part Number:  
338-0040-01 - Orange  
338-0040-07 - Black

Parts List			
ITEM	QTY	PART NUMBER	DESCRIPTION
1	5	313-0002-00	5/8-11 NYL INS L/N ZC
2	5	318-0053-00	5/8-11 x 2 3/4 Carriage Bolt Zinc GR 5
3	1	326-0236-01	5' UHMW Blade Backer- Orange
4	1	326-0236-07	5' UHMW Blade Backer- Black
5	1	338-0040-00	5 FT UHMW Blade

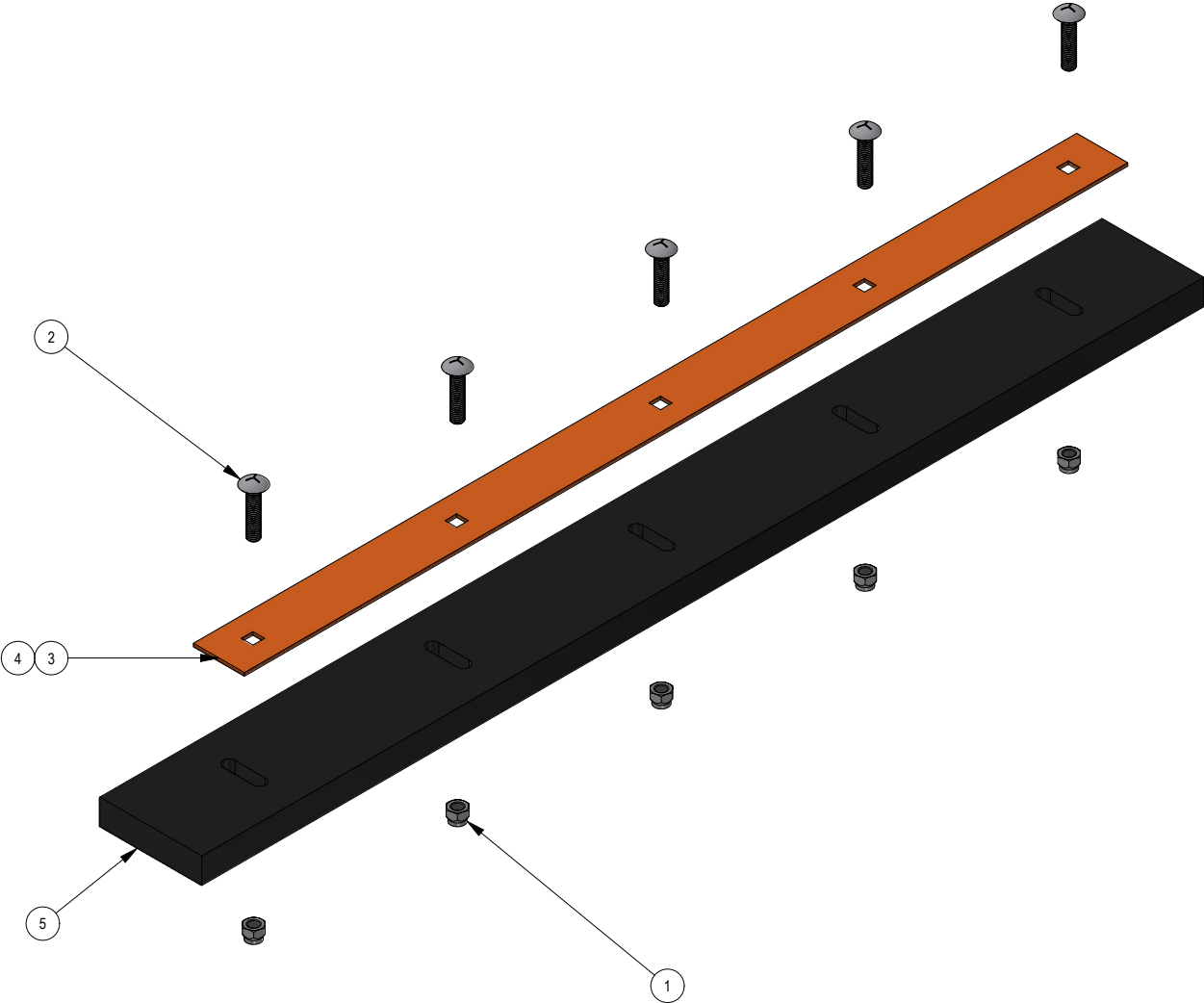

PARTS SECTION: 5' Snow Pusher Metal Blade Kit (338-0044-01)

Parts List			
ITEM	QTY	PART NUMBER	DESCRIPTION
1	5	313-0002-00	5/8-11 NYL INS L/N ZC
2	5	318-5020-00	No.3 Round Regular Head Countersunk Square Neck Plow Bolt - UNC BB
3	1	338-0007-00	60" LG/BB blade

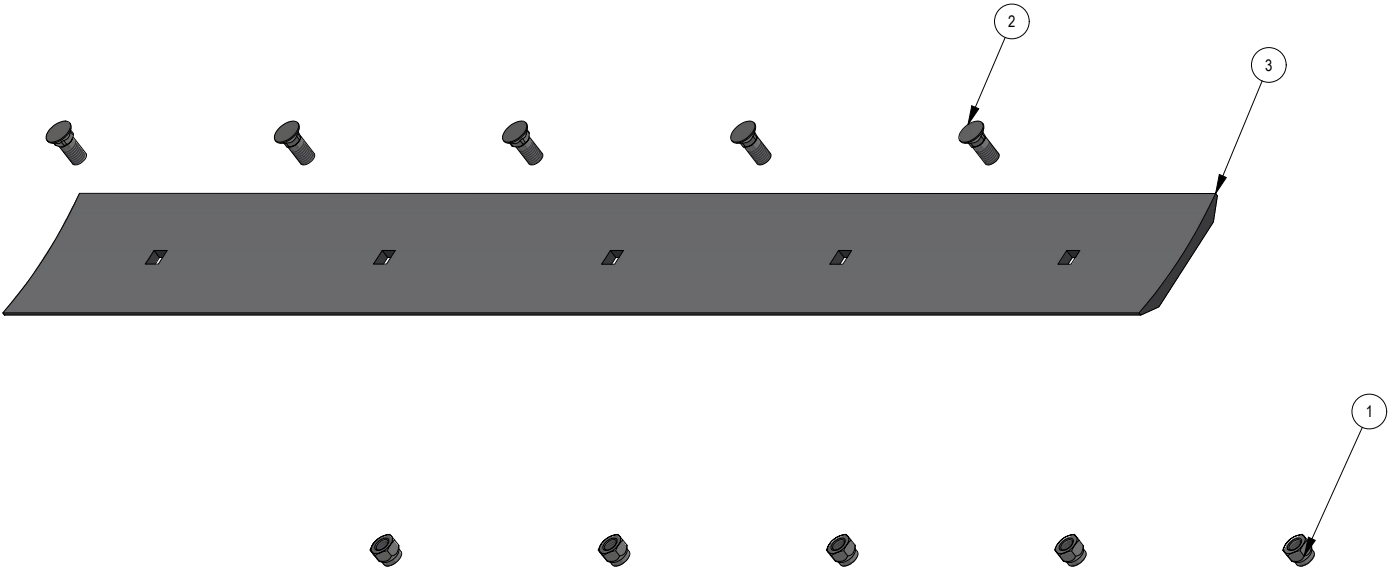

## PARTS SECTION: 6' Snow Pusher (BBSP72)

SKUs:

BBSP72O BBSP72BDO BBSP72UHO BBSP72UHBD0  
BBSP72BK BBSP72BDBK BBSP72UHBK BBSP72UHBDBK

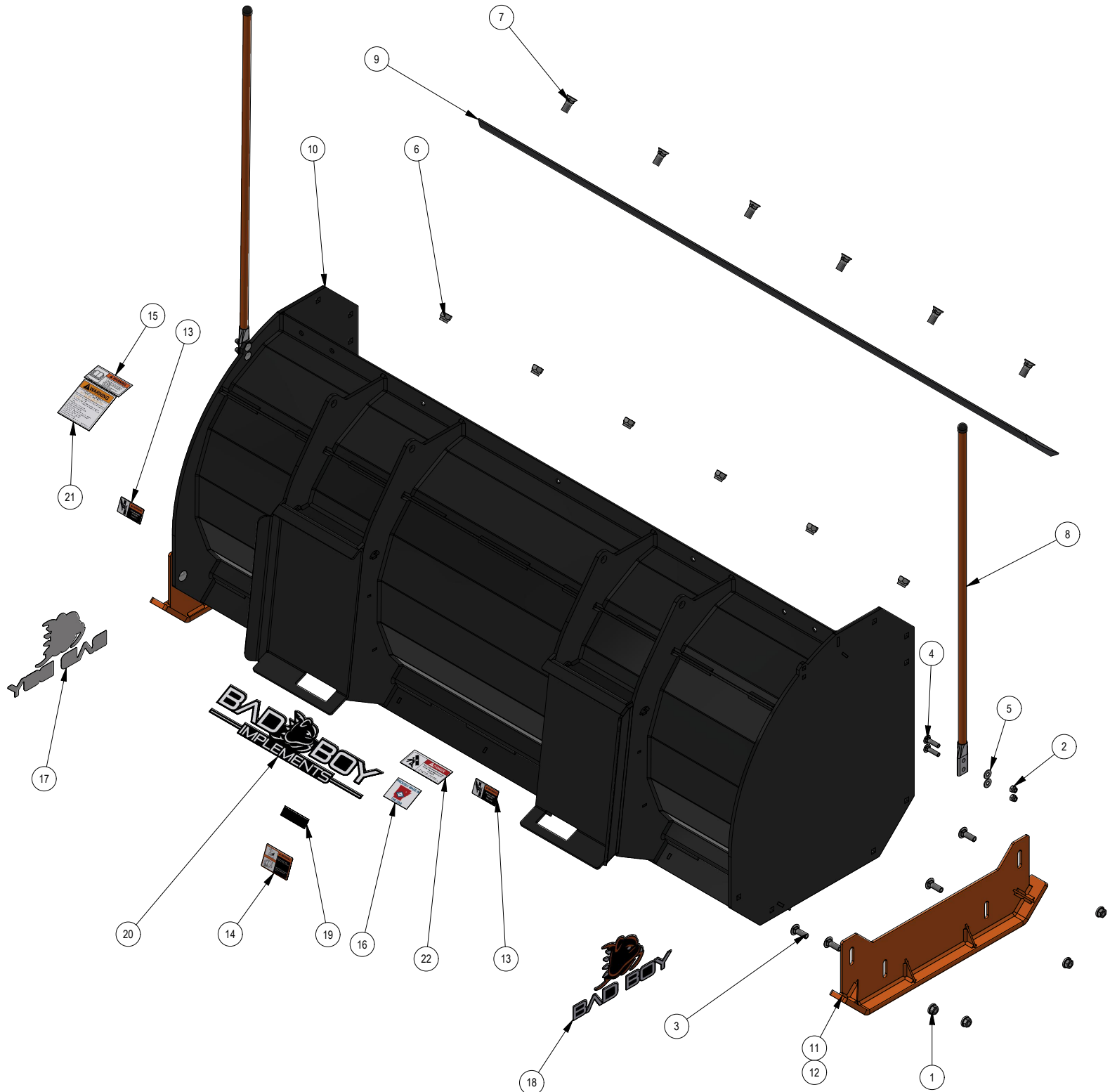

## PARTS SECTION: 6' Snow Pusher (BBSP72)

Parts List			
ITEM	QTY	PART NUMBER	DESCRIPTION
1	8	013-0010-00	1/2-13 HEX FLANGE AUTO OVAL LOCKNUT (GR.F) ZINC/WAX
2	4	013-5041-00	3/8-16 NYLON INSERT LOCKNUT ZINC
3	8	018-0008-00	1/2-13 X 1-1/2 CARRIAGE BOLT (GR.5) ZINC
4	4	018-4706-00	3/8-16 X 1-1/2 CARRIAGE BOLT ZINC
5	4	019-8044-00	5/16 USS FLAT WASHER (7/8 OD) ZINC
6	6	313-0002-00	5/8-11 NYL INS L/N ZC
7	6	318-5020-00	No.3 Round Regular Head Countersunk Square Neck Plow Bolt - UNC BB
8	2	335-0004-00	36' Snow Pusher Blade Marker
9	1	338-0005-00	72" LG/BB Blade
10	1	388-3059-00	6' Snow Pusher Weldment
11	2	388-3060-00	snow pusher skid weldment
12	2	388-3060-07	Snow Pusher Skid Weldment - Black
13	2	391-0032-00	Implement Pinch Point Decal
14	1	391-0034-00	Quick Attach Levers Warning Decal
15	1	391-0037-00	Read Manual Decal
16	1	391-0040-00	Made in the USA
17	1	391-0059-00	Tiller/Box Cutter Bad Boy Left Decal 12.94"
18	1	391-0060-00	Tiller/Box Cutter Bad Boy Right Decal 12.94"
19	1	391-0062-00	Black 1.25"x4.25"
20	1	391-0069-00	Implements Logo Decal
21	1	391-0070-00	General Warning Decal Non Rotating
22	1	391-0071-00	Roll Over Crush Hazard Decal



## PARTS SECTION: 6' Back Drag Kit

Kit Part Number:

388-0013-01 - Orange

388-0013-07 - Black

Parts List			
ITEM	QTY	PART NUMBER	DESCRIPTION
1	13	013-0010-00	1/2-13 HEX FLANGE AUTO OVAL LOCKNUT (GR.F) ZINC/WAX
2	13	018-0008-00	1/2-13 X 1-1/2 CARRIAGE BOLT (GR.5) ZINC
3	6	313-0002-00	5/8-11 NYL INS L/N ZC
4	6	318-5020-00	No.3 Round Regular Head Countersunk Square Neck Plow Bolt - UNC BB
5	1	338-0005-00	72" LG/BB Blade
6	1	388-0012-00	6ft Backdrag Weldment
7	1	388-0012-07	6ft Backdrag Weldment- black

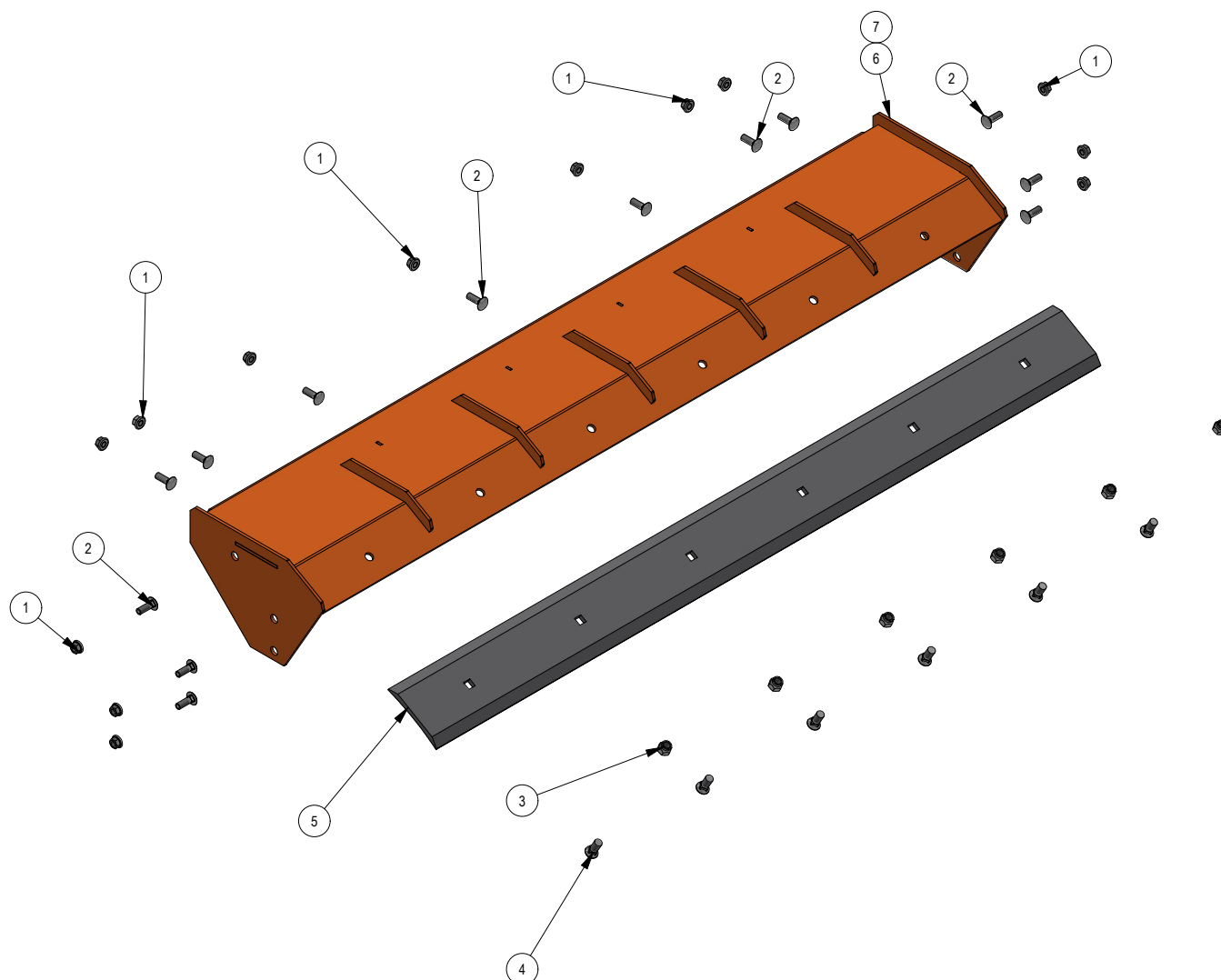

## PARTS SECTION: 6' UHMW Back Drag Kit

Kit Part Number:

388-0026-01 - Orange

388-0026-07 - Black

Parts List

ITEM	QTY	PART NUMBER	DESCRIPTION
1	13	013-0010-00	1/2-13 HEX FLANGE AUTO OVAL LOCKNUT (GR.F) ZINC/WAX
2	13	018-0008-00	1/2-13 X 1-1/2 CARRIAGE BOLT (GR.5) ZINC
3	6	313-0002-00	5/8-11 NYL INS L/N ZC
4	6	318-0053-00	5/8-11 x 2 3/4 Carriage Bolt Zinc GR 5
5	1	326-0237-01	6' UHMW Blade Backer- Orange
6	1	338-0039-00	6ft UHMW Blade
7	1	388-0012-00	6ft Backdrag Weldment
8	1	388-0012-07	6ft Backdrag Weldment- black

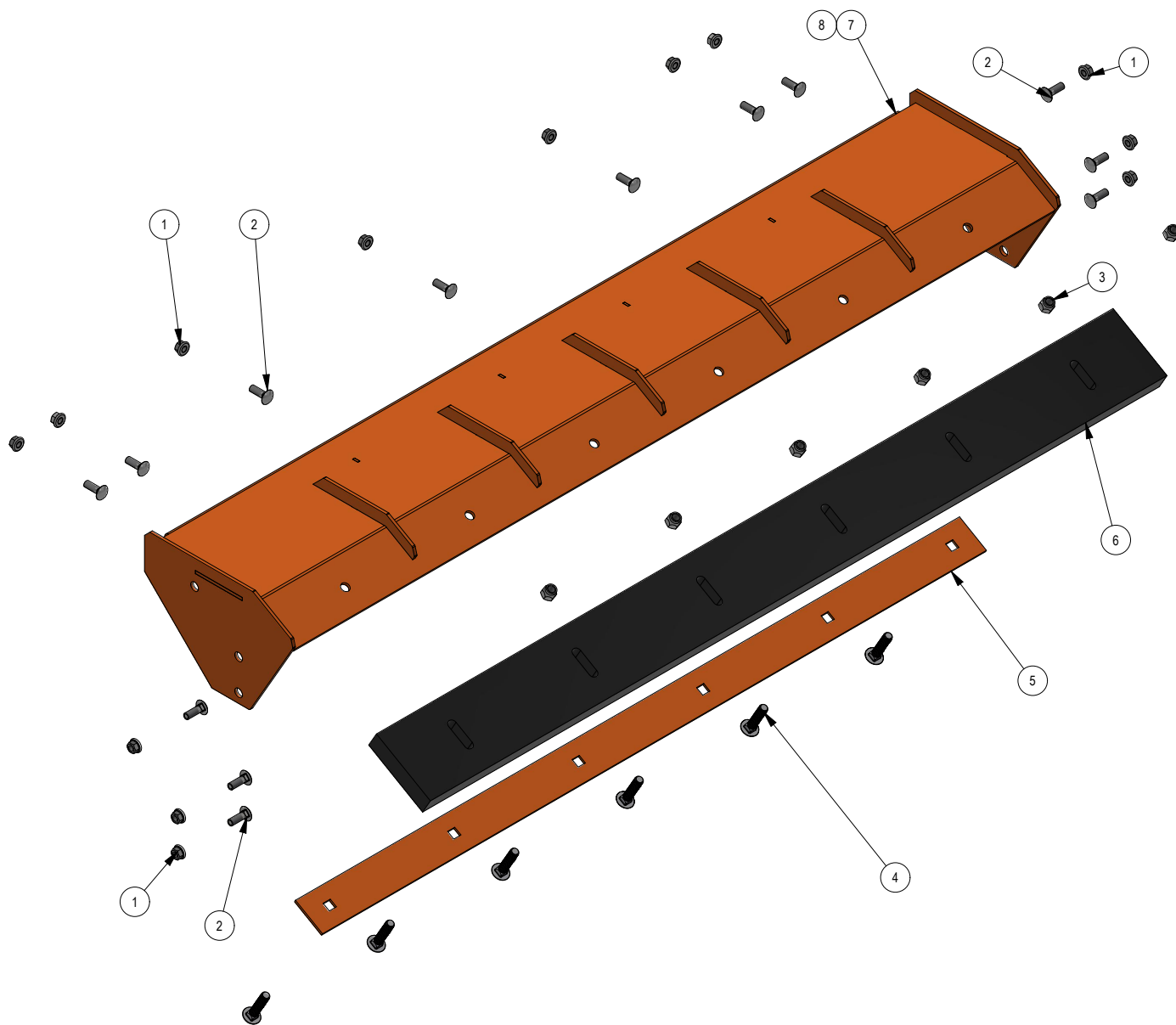

**PARTS SECTION: 6' UHMW Blade Kit**

Kit Part Number:  
338-0039-01 - Orange  
338-0039-07 - Black

Parts List			
ITEM	QTY	PART NUMBER	DESCRIPTION
1	6	313-0002-00	5/8-11 NYL INS L/N ZC
2	6	318-0053-00	5/8-11 x 2 3/4 Carriage Bolt Zinc GR 5
3	1	326-0237-01	6' UHMW Blade Backer- Orange
4	1	326-0237-07	6' UHMW Blade Backer - Black
5	1	338-0039-00	6ft UHMW Blade

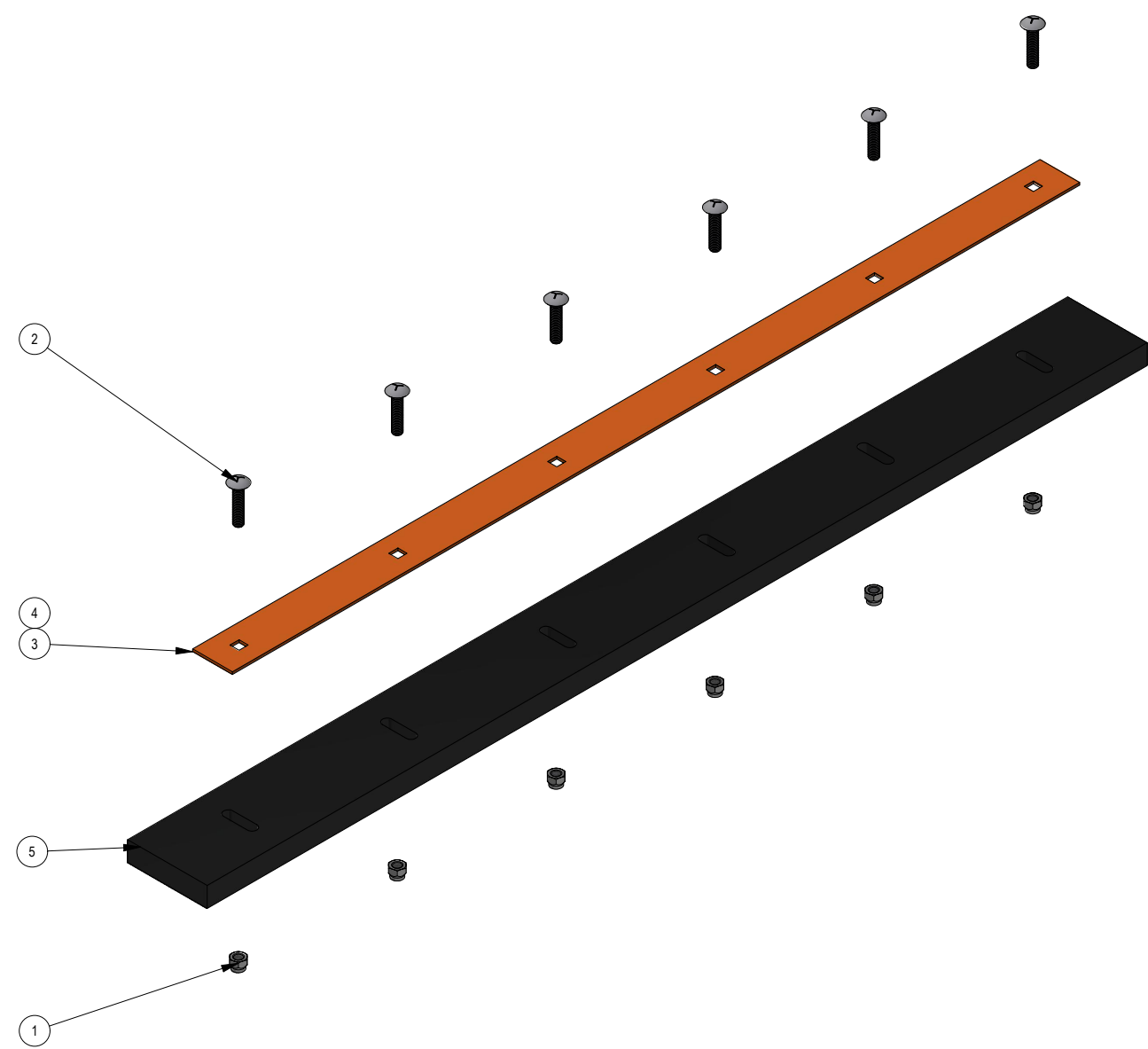

**PARTS SECTION: 6' Snow Pusher Metal Blade Kit(338-0045-01)**

Parts List			
ITEM	QTY	PART NUMBER	DESCRIPTION
1	1	338-0005-00	72" LG/BB Blade
2	6	313-0002-00	5/8-11 NYL INS L/N ZC
3	6	318-5020-00	No.3 Round Regular Head Countersunk Square Neck Plow Bolt - UNC BB

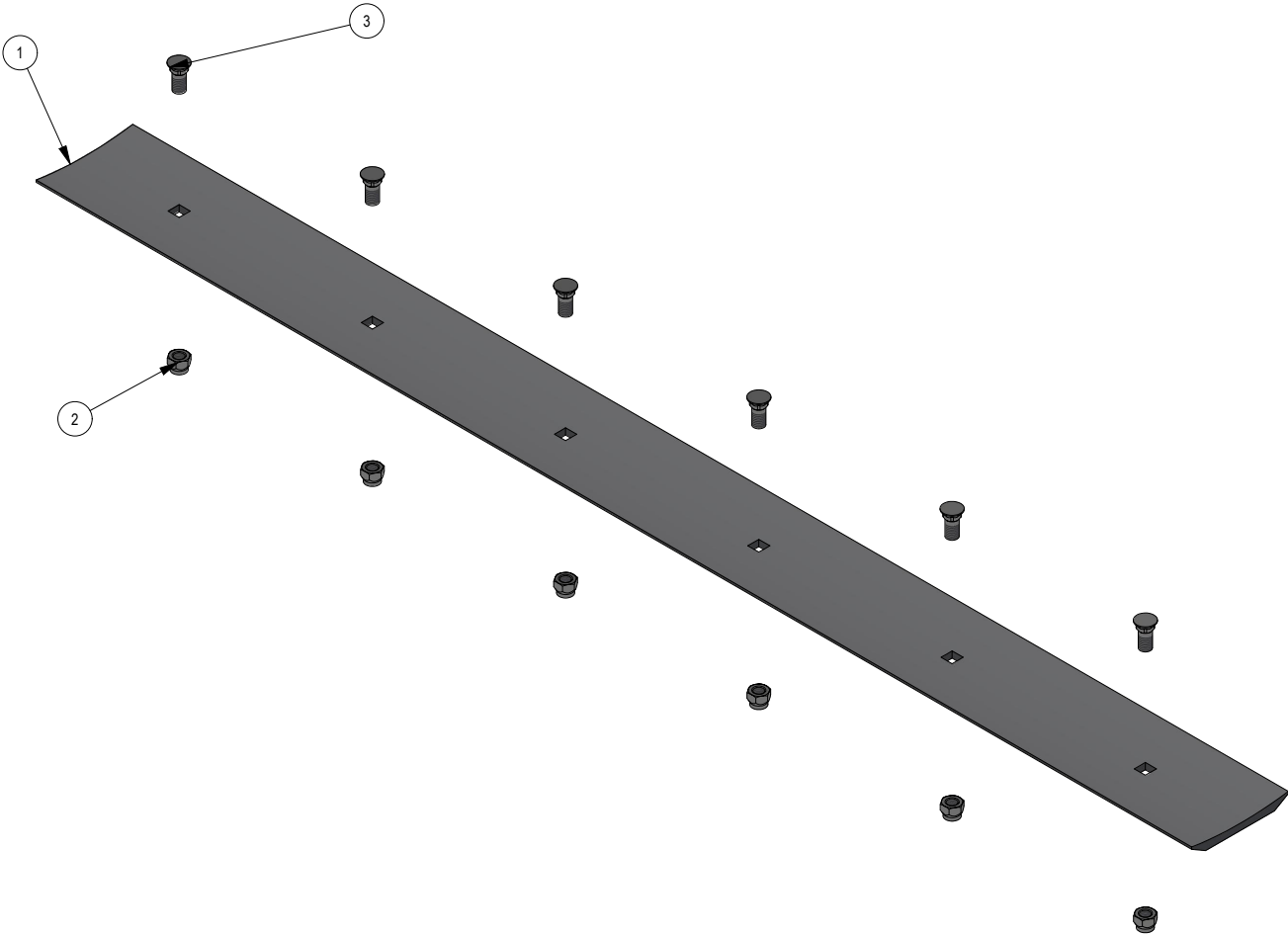

## PARTS SECTION: 7' Snow Pusher (BBSP84)

SKUs:

BBSP84O BBSP84BDO BBSP84UHO BBSP84UHBDO  
BBSP84BK BBSP84BDBK BBSP72UHBK BBSP84UHBDBK

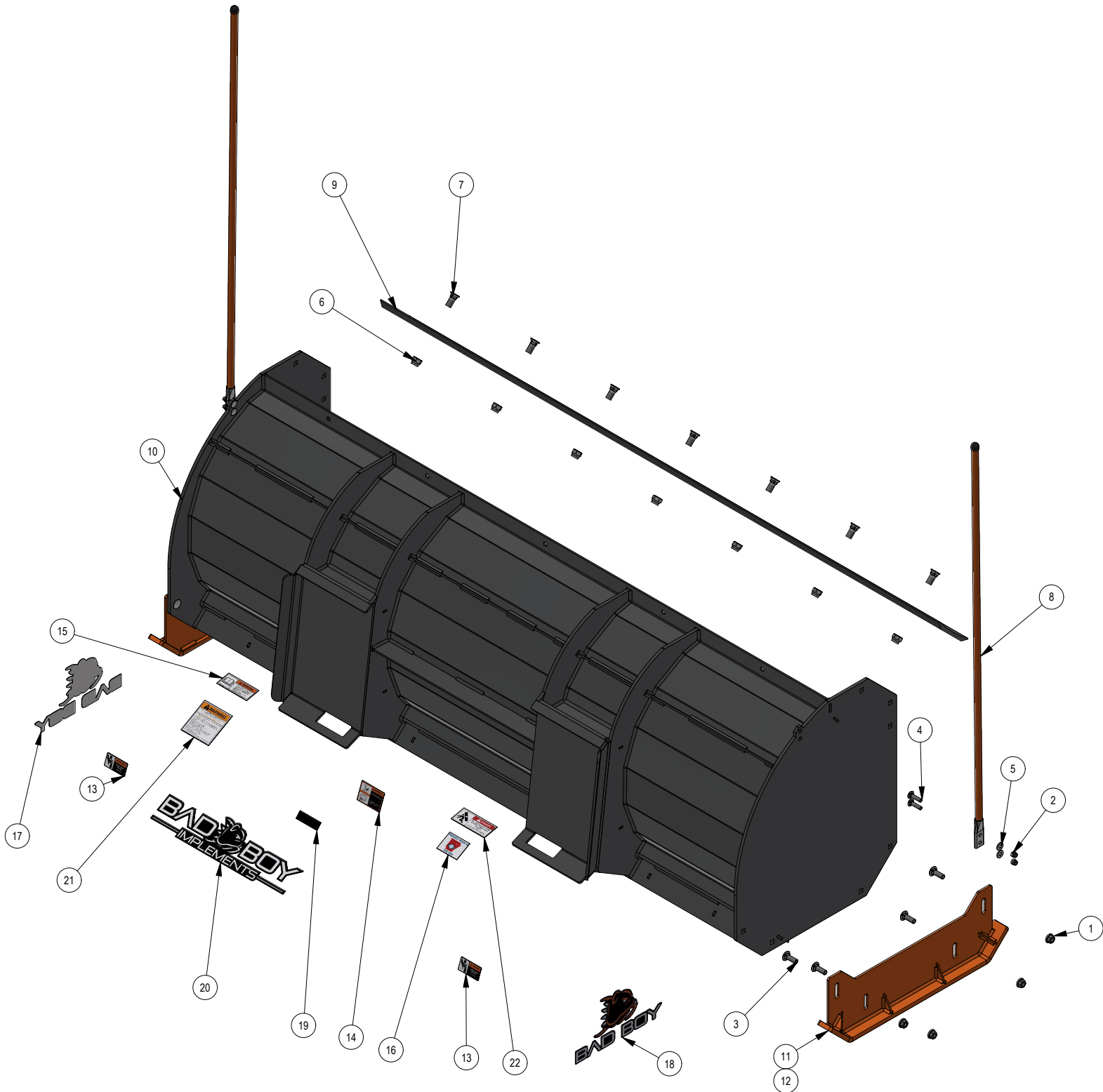

## PARTS SECTION: 7' Snow Pusher (BBSP84)

Parts List			
ITEM	QTY	PART NUMBER	DESCRIPTION
1	8	013-0010-00	1/2-13 HEX FLANGE AUTO OVAL LOCKNUT (GR.F) ZINC/WAX
2	4	013-5041-00	3/8-16 NYLON INSERT LOCKNUT ZINC
3	8	018-0008-00	1/2-13 X 1-1/2 CARRIAGE BOLT (GR.5) ZINC
4	4	018-4706-00	3/8-16 X 1-1/2 CARRIAGE BOLT ZINC
5	4	019-8044-00	5/16 USS FLAT WASHER (7/8 OD) ZINC
6	7	313-0002-00	5/8-11 NYL INS L/N ZC
7	7	318-5020-00	No.3 Round Regular Head Countersunk Square Neck Plow Bolt - UNC BB
8	2	335-0005-00	48" Snow Pusher Blade Marker
9	1	338-0009-00	84" LG/BB Blade
10	1	388-0018-00	7' Snow Pusher Weldment
11	2	388-3060-00	snow pusher skid weldment
12	2	388-3060-07	Snow Pusher Skid Weldment - Black
13	2	391-0032-00	Implement Pinch Point Decal
14	1	391-0034-00	Quick Attach Levers Warning Decal
15	1	391-0037-00	Read Manual Decal
16	1	391-0040-00	Made in the USA
17	1	391-0059-00	Tiller/Box Cutter Bad Boy Left Decal 12.94"
18	1	391-0060-00	Tiller/Box Cutter Bad Boy Right Decal 12.94"
19	1	391-0062-00	Black 1.25"x4.25"
20	1	391-0069-00	Implements Logo Decal
21	1	391-0070-00	General Warning Decal Non Rotating
22	1	391-0071-00	Roll Over Crush Hazard Decal

## PARTS SECTION: 7' Back Drag Kit

Kit Part Number:

388-0017-01 - Orange

388-0017-07 - Black

Parts List			
ITEM	QTY	PART NUMBER	DESCRIPTION
1	13	013-0010-00	1/2-13 HEX FLANGE AUTO OVAL LOCKNUT (GR.F) ZINC/WAX
2	13	018-0008-00	1/2-13 X 1-1/2 CARRIAGE BOLT (GR.5) ZINC
3	7	313-0002-00	5/8-11 NYL INS L/N ZC
4	7	318-5020-00	No.3 Round Regular Head Countersunk Square Neck Plow Bolt - UNC BB
5	1	338-0009-00	84" LG/BB Blade
6	1	388-0016-00	7' Snow pusher Backdrag Weldment
7	1	388-0016-07	7' Snow pusher Backdrag Weldment-Black

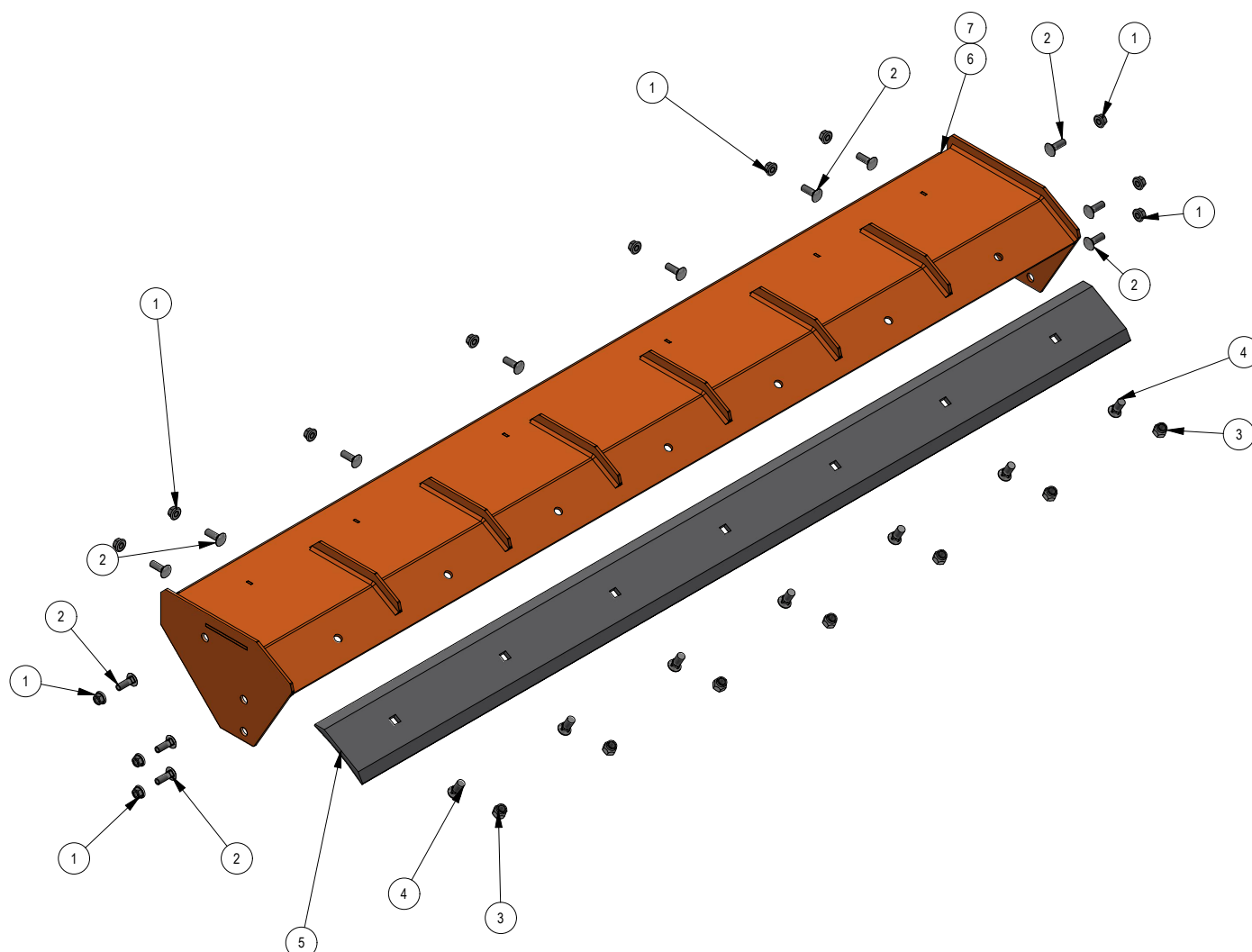

## PARTS SECTION: 7' Back Drag Kit

Kit Part Number:

388-0027-01 - Orange

388-0027-07 - Black

Parts List			
ITEM	QTY	PART NUMBER	DESCRIPTION
1	13	013-0010-00	1/2-13 HEX FLANGE AUTO OVAL LOCKNUT (GR.F) ZINC/WAX
2	13	018-0008-00	1/2-13 X 1-1/2 CARRIAGE BOLT (GR.5) ZINC
3	7	313-0002-00	5/8-11 NYL INS L/N ZC
4	7	318-0053-00	5/8-11 x 2 3/4 Carriage Bolt Zinc GR 5
5	1	326-0238-01	7' UHMW Blade Backer- Orange
6	1	338-0041-00	7ft UHMW Blade
7	1	388-0016-00	7' Snow pusher Backdrag Weldment
8	1	388-0016-07	7' Snow pusher Backdrag Weldment-Black

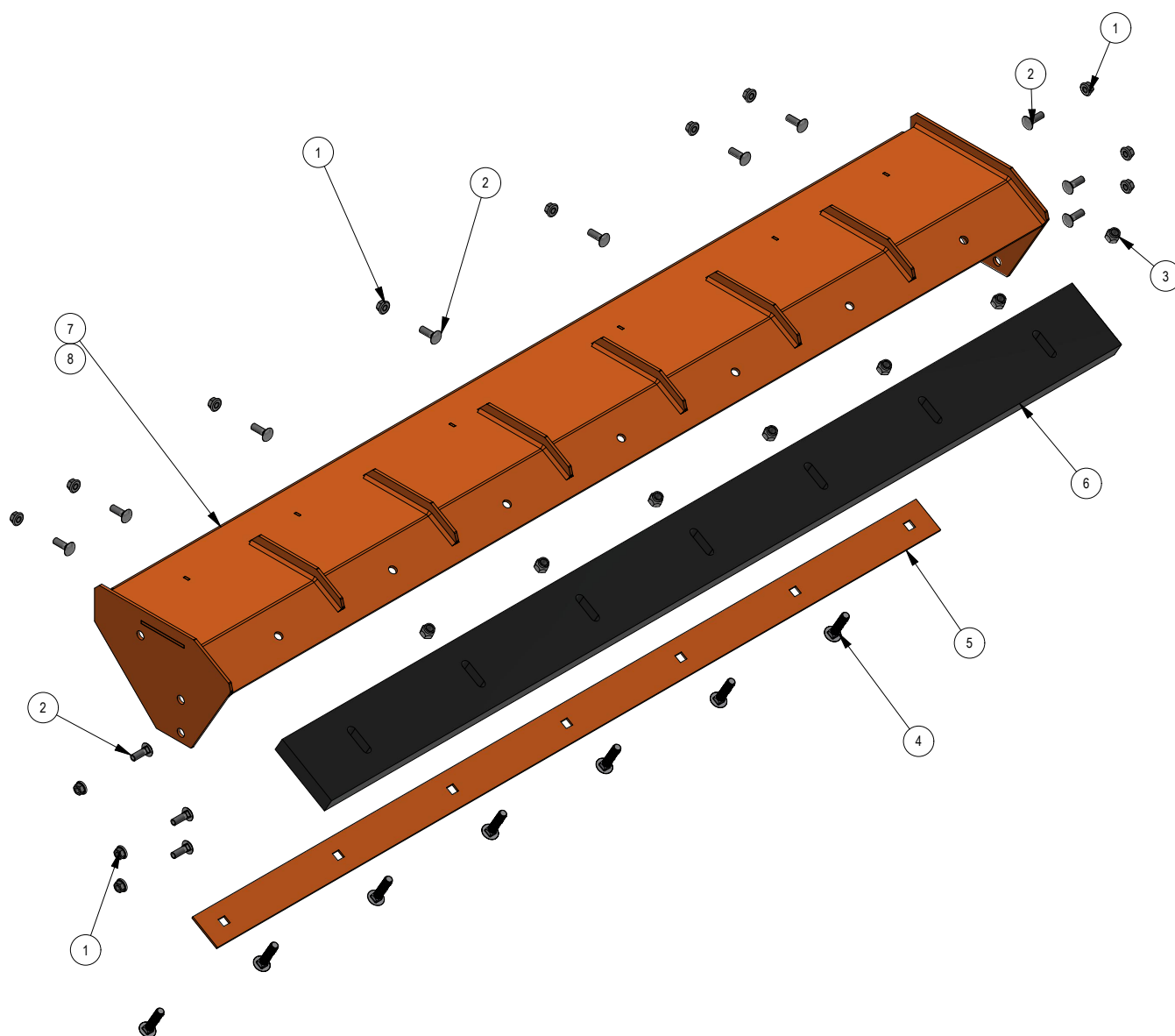



PARTS SECTION: 7' UHMW Blade Kit

Kit Part Number:  
338-0041-01 - Orange  
338-0041-07 - Black

Parts List			
ITEM	QTY	PART NUMBER	DESCRIPTION
1	7	313-0002-00	5/8-11 NYL INS L/N ZC
2	7	318-0053-00	5/8-11 x 2 3/4 Carriage Bolt Zinc GR 5
3	1	326-0238-01	7' UHMW Blade Backer- Orange
4	1	326-0238-07	7' UHMW Blade Backer - Black
5	1	338-0041-00	7ft UHMW Blade

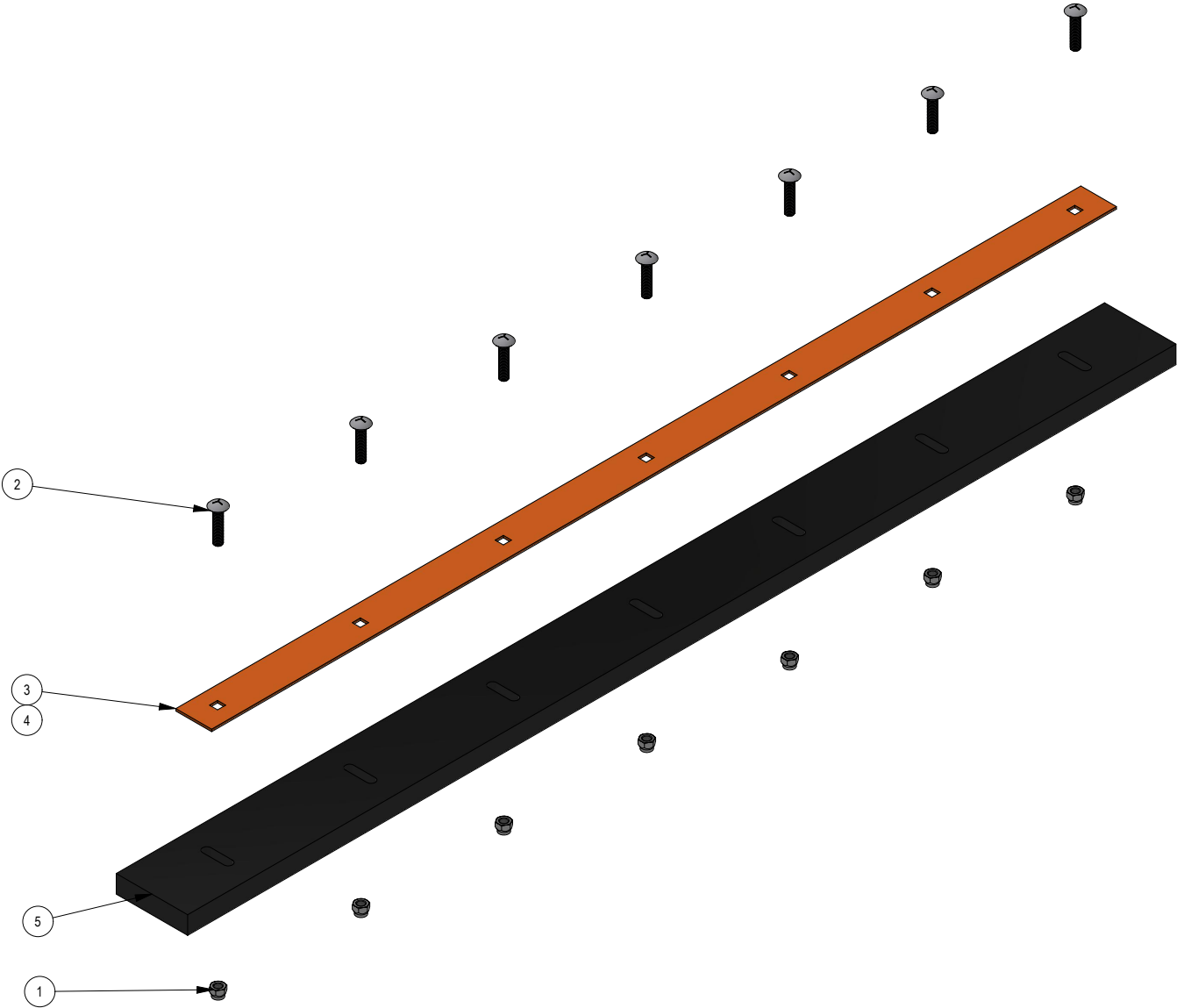

**PARTS SECTION: 7' Snow Pusher Metal Blade Kit (338-0046-01)**

Parts List			
ITEM	QTY	PART NUMBER	DESCRIPTION
1	7	313-0002-00	5/8-11 NYL INS L/N ZC
2	7	318-5020-00	No.3 Round Regular Head Countersunk Square Neck Plow Bolt - UNC BB
3	1	338-0009-00	84" LG/BB Blade

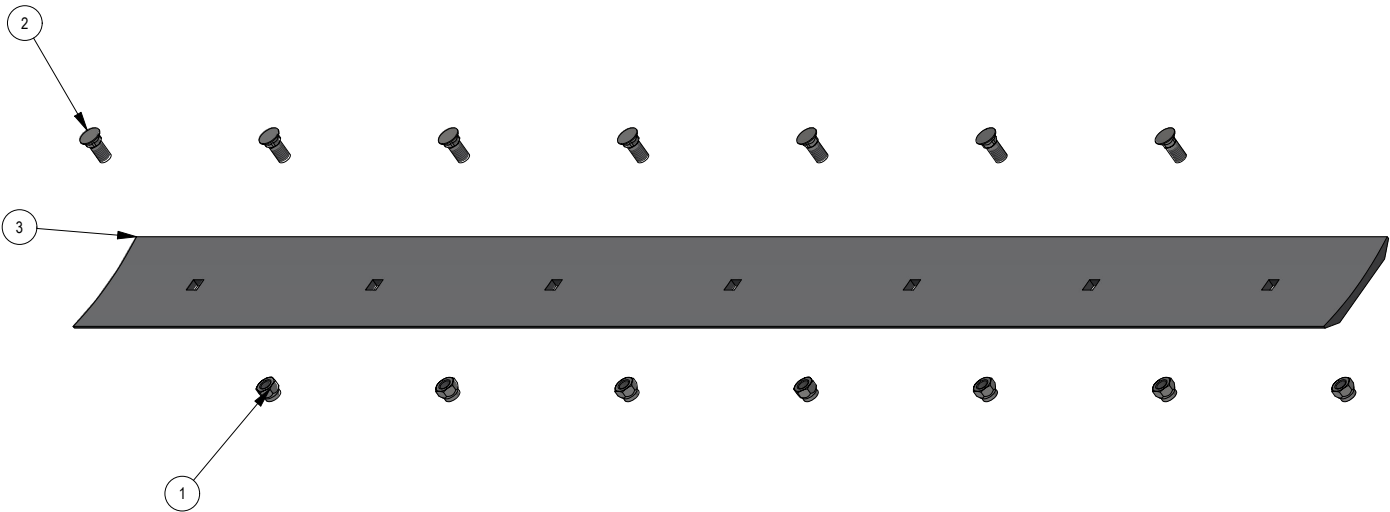

**PARTS SECTION: UHMW Skid Shoe Kit**

Kit Part Number:  
338-0038-01 - Orange  
338-0038-07 - Black

Parts List			
ITEM	QTY	PART NUMBER	DESCRIPTION
1	8	013-0010-00	1/2-13 HEX FLANGE AUTO OVAL LOCKNUT (GR.F) ZINC/WAX
2	8	018-0067-00	1/2-13 x 3 Carriage Bolt Grade 5
3	2	039-0572-01	UHMW Skid retainer bracket -Orange
4	2	039-0572-07	UHMW Skid retainer bracket - Black
5	2	338-0038-00	Snow Pusher Skid UHMW

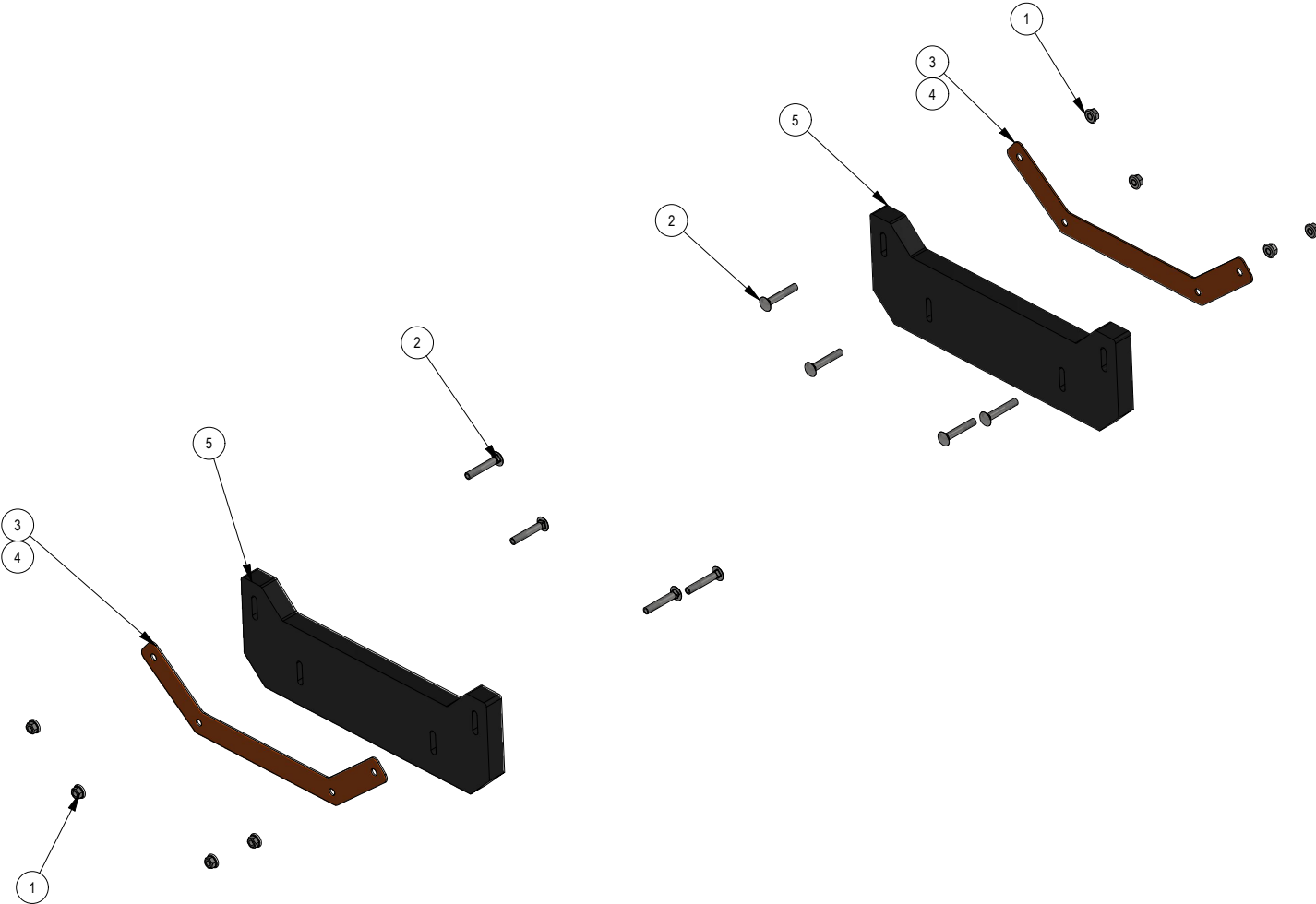

**PARTS SECTION: DECALS**

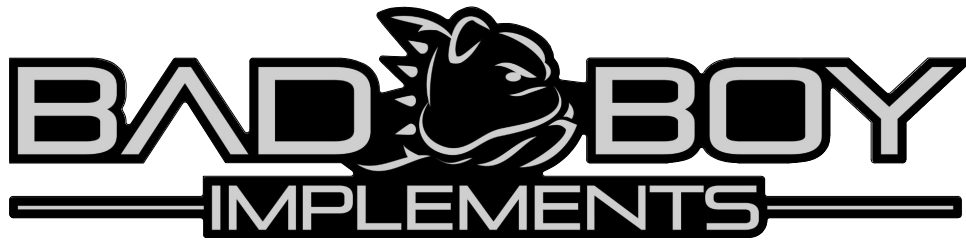

**391-0069-00**  
Implements Logo Decal



**391-0059-00**  
Tiller/Box Cutter Bad Boy  
Left Decal 12.94"



**391-0060-00**  
Tiller/Box Cutter Bad Boy  
Right Decal 12.94"

## PARTS SECTION: Decals Cont.



**391-0032-00**  
Grapple Pinch Point Decal



**391-0062-00**  
Black 1.25"x4.25" Decal

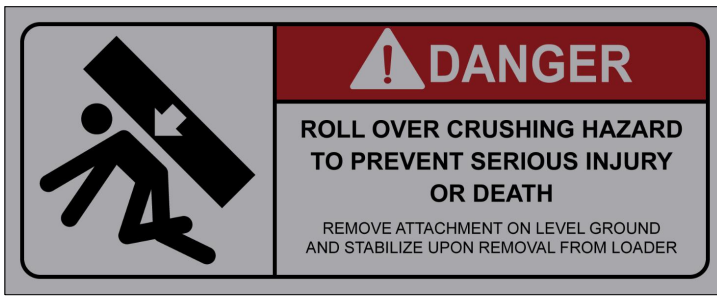

**391-0071-00**  
Snow Pusher Roll Over  
Crush Hazard Decal

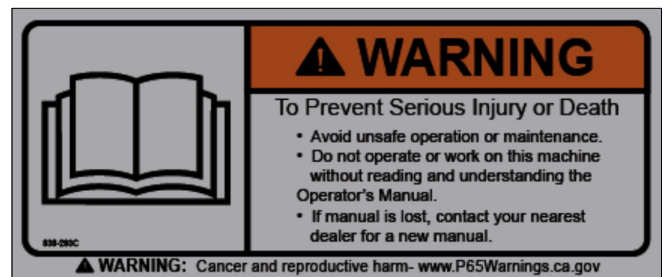

**391-0037-00**  
Pallet Fork Manual Decal



**391-0040-00**  
Made in the USA



**391-0040-00**  
Quick Attach Levers  
Warning Decal

## PARTS SECTION: Decals Cont.

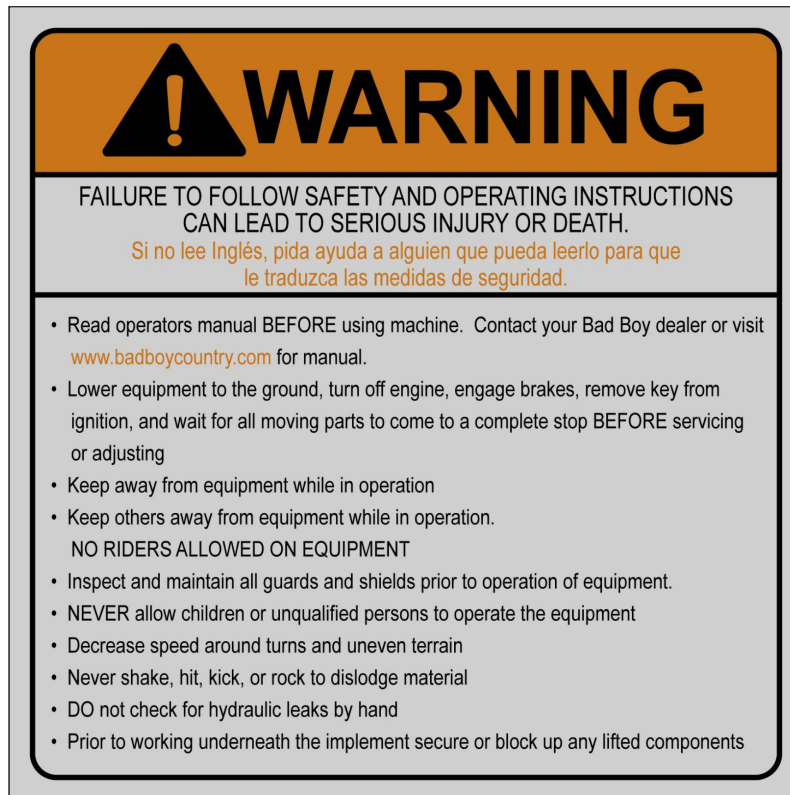

**391-0070-00**  
Snow Pusher Warning  
Decal



# BAD BOY IMPLEMENTS

[www.badboycountry.com](http://www.badboycountry.com)

Bad Boy Mowers, LLC  
102 Industrial Drive  
Batesville, Arkansas 72501